

# aiwa

8B-RT9-901-01  
001102AYO-OX  
Printed in Hong Kong

## FR-C402W

RADIO RECEIVER  
RECEPTOR DE RADIO

### OPERATING INSTRUCTIONS

AIWA CO.,LTD.

#### ENGLISH

##### OWNER'S RECORD

For your convenience, record the model number and serial number (you will find it inside the battery compartment of your set) in the space provided below. Please refer to them when you contact your AIWA dealer in case of difficulty.

Model No.

Serial No.

### PRECAUTIONS

#### To maintain good performance

- Do not use the unit in places which are extremely hot, cold, dusty or humid.  
In particular, do not keep the unit:
  - in a high humidity area such as a bathroom
  - near a heater
  - in an area exposed to direct sunlight (inside a parked car, where there could be a considerable rise in temperature)
- Keep cassette tapes, magnetic cards and other magnetic recorded materials away from the speaker as the recorded information may be erased or noise may be heard on cassette tapes.

### TO INSERT DRY CELL BATTERIES → **A**

Insert three size AA (R6) batteries with the  $\oplus$  and  $\ominus$  marks properly aligned.

#### Battery replacement

Replace the batteries when the sound becomes distorted.

**A**

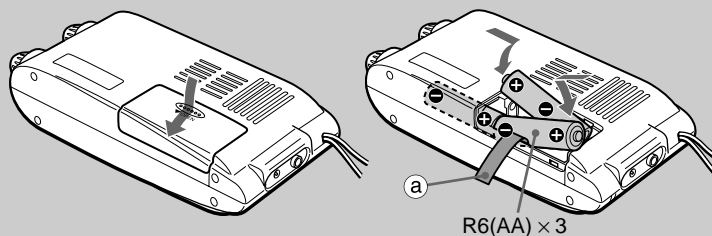

**B**

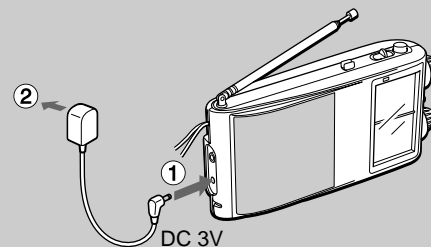

dusty or humid.

- In particular, do not keep the unit:
- in a high humidity area such as a bathroom
- near a heater
- in an area exposed to direct sunlight (inside a parked car, where there could be a considerable rise in temperature)
- Keep cassette tapes, magnetic cards and other magnetic recorded materials away from the speaker as the recorded information may be erased or noise may be heard on cassette tapes.

## TO INSERT DRY CELL BATTERIES → **A**

Insert three size AA (R6) batteries with the **+** and **-** marks properly aligned.

### Battery replacement

Replace the batteries when the sound becomes distorted.

**To remove the batteries**, pull up the ribbon **Ⓐ**.

### Battery life (EIAJ 10 mW)

Battery	AM reception	FM, TV, WEATHER reception
Manganese (R6P) batteries	Approx. 46 hours	Approx. 40 hours
Alkaline (LR6) batteries	Approx. 140 hours	Approx. 120 hours

### Note on dry cell batteries

- Make sure that the **+** and **-** marks are correctly aligned.
- Do not mix different types of batteries, or an old battery with a new one.
- Never recharge the batteries, apply heat to them or take them apart.
- When not using the batteries, remove them to prevent needless wear.
- If liquid leaks from the batteries, wipe thoroughly to remove.

### To use on AC house current

Contact your nearest Aiwa service personnel and purchase the AC adaptor Aiwa AC-D302.

Connect the AC adaptor.

① to DC 3 V jack

② to a wall outlet

### Note

Before using on batteries, disconnect the plug of AC adaptor from the DC 3 V jack.

Battery power is cut automatically when the plug is connected.

### CAUTION

Modifications or adjustments to this product, which are not expressly approved by the manufacturer, may void the user's right or authority to operate this product.

This device complies with Part 15 of the FCC Rules. Operation is subject to the condition that this device does not cause harmful interference.

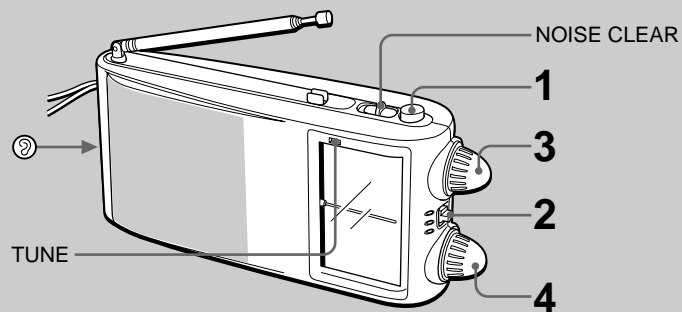
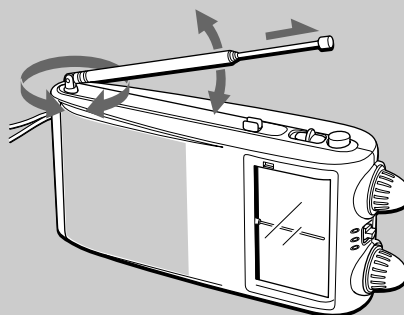
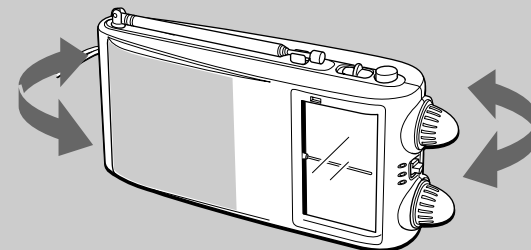
**C****D****FM, TV<sub>L</sub>, TV<sub>H</sub>, WEATHER****AM****ENGLISH****RADIO RECEPTION → C****1 Press the POWER button to turn on the power.****2 Select a band.**Set the BAND switch to FM/TV<sub>L</sub> for TV 2 ch – 6 ch reception.Set the switch to WEATHER/TV<sub>H</sub> for TV 7 ch – 13 ch reception.**3 Turn the TUNING control to tune in to a station.**

When a station is tuned in to, the TUNE indicator lights.

**4 Adjust the volume.**

After listening, press the POWER button to turn off the radio.

**When the broadcast signal is weak**

Set the NOISE CLEAR switch to ON. The high frequencies are de-emphasized, however, the sound may be heard more clearly.

**Listening with the earphone**

Connect an optional earphone (with a monaural mini-plug) to the Ⓒ jack.

The sound from the speaker will not be heard when the earphone is connected.

**For better reception → D****FM, TV<sub>L</sub>, TV<sub>H</sub>, WEATHER:**

Extend the FM antenna and orient it for the best reception.

**AM:** Turn the unit to find the position which gives the best reception.**MAINTENANCE****To clean the cabinet**

### Listening with the earphone

Connect an optional earphone (with a monaural mini-plug) to the  jack.

The sound from the speaker will not be heard when the earphone is connected.

### For better reception → **D**

FM, TV<sub>L</sub>, TV<sub>H</sub>, WEATHER:

Extend the FM antenna and orient it for the best reception.

AM: Turn the unit to find the position which gives the best reception.

## MAINTENANCE

### To clean the cabinet

Use a soft cloth lightly moistened with a mild detergent solution.

Do not use the strong solvents such as alcohol, benzine or cleaner.

## SPECIFICATIONS

<b>Frequency range</b>	AM: 530 – 1,710 kHz
	FM: 87.5 – 108 MHz
	TV <sub>L</sub> : 2 ch – 6 ch
	TV <sub>H</sub> : 7 ch – 13 ch
	WEATHER: 1 ch – 7 ch
<b>Maximum output</b>	200 mW (EIAJ 8 ohms)
<b>Speaker</b>	Diameter 66 mm, 8 ohms
<b>Power source</b>	DC 4.5 V using three size AA (R6)
	batteries
	AC house current using AC adaptor
	Aiwa AC-D302
<b>Maximum outside dimensions</b>	
	160 (W) × 81 (H) × 40 (D) mm
	(6 <sup>3</sup> / <sub>8</sub> × 3 <sup>1</sup> / <sub>4</sub> × 1 <sup>5</sup> / <sub>8</sub> in.)
<b>Weight</b>	Approx. 250 g (8,8 oz.) (excluding batteries)

The specifications and external appearance of this unit are subject to change without notice.