

## Overview

### Special Features

- ❑ **Leading Technology** — With Intel® Centrino™ mobile technology, experience optimized mobile computing
- ❑ **Got Wireless?** — Integrated Bluetooth™ technology and IEEE 802.11b/g wireless LAN for truly mobile network connections<sup>1</sup>
- ❑ **Enjoy Movies** — Watch DVD movies anywhere with an integrated CD-RW/DVD combo drive, long-life battery, and large display

### Software

- ❑ **Operating System** — Microsoft® Windows® XP Professional
- ❑ **Audio and Video Authoring, Viewing, and Sharing** — Powerful software for creating and sharing movies and managing audio files

### Hardware

- ❑ **Exceptional Performance** — Fast Intel® Pentium® M processor 1.70 GHz<sup>2</sup>
- ❑ **Power** — High-capacity lithium-ion battery
- ❑ **Portability** — Approximately 4.7 pounds light (with standard battery)
- ❑ **Usability** — Large display, generous hard drive, expandable memory:
  - ❑ 14.1" SXGA+ TFT display (LCD)
  - ❑ 60 or 80 GB<sup>3</sup> hard disk drive; 4200 RMPs
  - ❑ 512 MB or 1 GB<sup>4</sup> (max. 1 GB) DDR SDRAM
- ❑ **Connectivity** —
  - ❑ Built-in wireless LAN<sup>1</sup>
  - ❑ Integrated Bluetooth Technology
  - ❑ i.LINK®<sup>5</sup>S400 port (4-pin)
  - ❑ USB 2.0<sup>6</sup> ports (2)
  - ❑ Monitor port (VGA)
  - ❑ 10BASE-T/100BASE-TX Ethernet port (RJ-45)
  - ❑ Modem line jack (RJ-11)
  - ❑ Memory Stick® media slot<sup>7</sup>
  - ❑ Headphones jack
  - ❑ Microphone jack
  - ❑ Port replicator connector

### Front

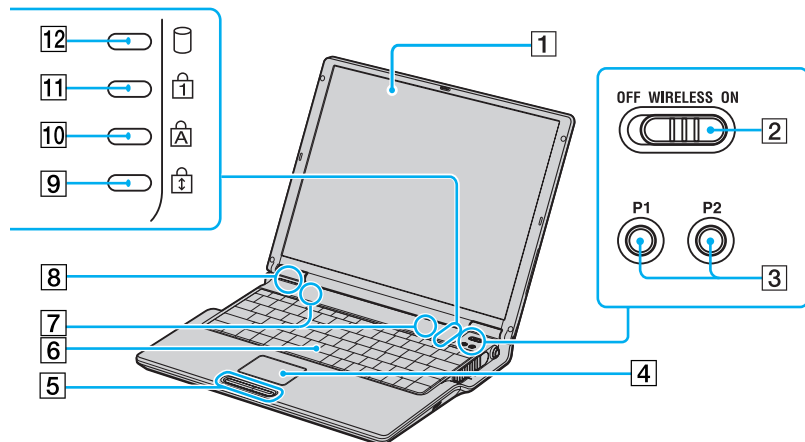

### Front

- |   |                        |    |                           |
|---|------------------------|----|---------------------------|
| 1 | Display (LCD)          | 7  | Speakers                  |
| 2 | Wireless LAN switch    | 8  | Model number              |
| 3 | Pre-programmable keys  | 9  | Scroll lock indicator     |
| 4 | Touch pad              | 10 | Caps lock indicator       |
| 5 | Left and right buttons | 11 | Num lock indicator        |
| 6 | Keyboard               | 12 | Hard disk drive indicator |

- 1 Wireless LAN Access Point device sold separately. Sony cannot fully guarantee the security of wireless communications.
- 2 GHz denotes maximum microprocessor internal clock speed; other factors may affect application performance.
- 3 GB means 1 billion bytes when referring to hard disk drive capacity. Accessible capacity may vary. A portion of hard disk space is reserved as a recovery partition.
- 4 One GB is equal to 1,024 MB.
- 5 i.LINK is a trademark of Sony used to designate that a product contains an IEEE 1394 connection. The i.LINK connection may vary, depending on the software applications, operating system, and compatible i.LINK devices. All products with an i.LINK connection may not communicate with each other. Please refer to the documentation that came with your compatible i.LINK device for information on operating conditions and proper connection. Before connecting compatible i.LINK PC peripherals to your system, such as a CD-RW or hard disk drive, confirm their operating system compatibility and required operating conditions.
- 6 Supports high, full, and low speeds.
- 7 Supports Memory Stick Pro™ high-capacity media. Tested to support up to 1 GB media capacity, does not support access control security function, such as MagicGate copyright protection in Memory Stick Pro media.

Specifications are subject to change.

**Right**

- 1 Battery indicator
- 2 Wireless LAN indicator
- 3 Bluetooth indicator
- 4 Power button
- 5 Modem link jack (RJ-11)
- 6 Air vent
- 7 Optical drive eject button
- 8 Optical drive

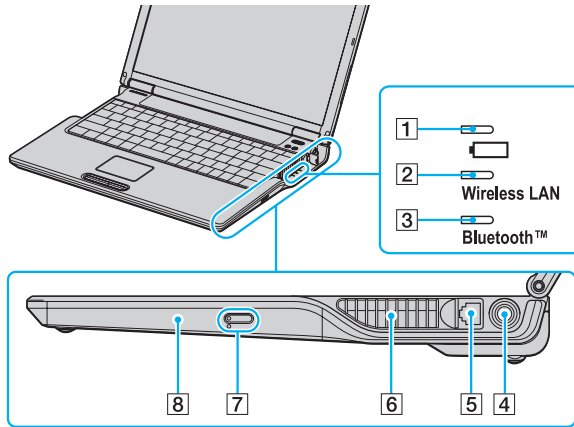

**Left**

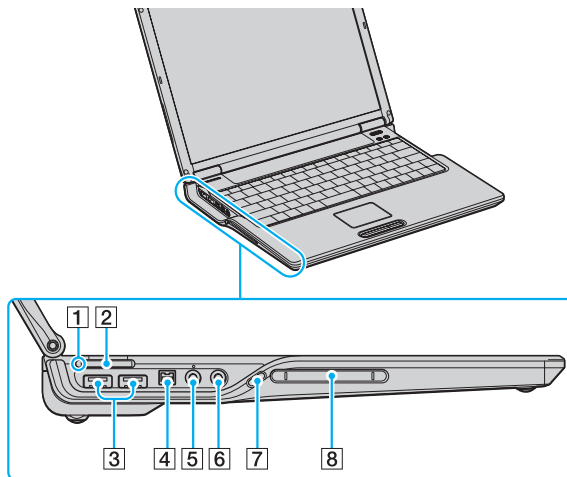

- 1 Memory Stick® media indicator
- 2 Memory Stick® media slot
- 3 USB 2.0 ports
- 4 i.LINK S400 port (4-pin)
- 5 Microphone jack
- 6 Headphones jack
- 7 PC Card slot eject button
- 8 PC Card slot

**Back**

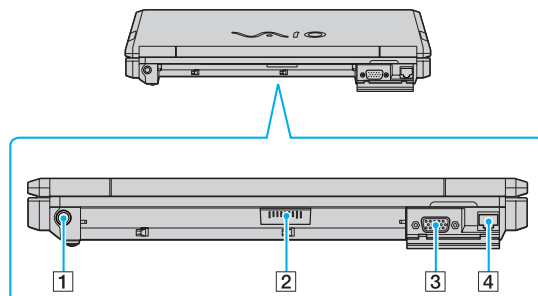

- 1 DC IN port
- 2 Battery port
- 3 Monitor port (VGA)
- 4 10BASE-T/100BASE-TX Ethernet port (RJ-45)

## Standard Features

<i>Feature</i>	<i>Description</i>
<b>Processor</b>	<b>Available:</b> Intel® Pentium® M processor 1.70 GHz <sup>1</sup>
<b>L2 Cache Memory</b>	1 MB (CPU Integrated)
<b>Operating System</b>	Microsoft® Windows® XP Professional
<b>Hard Disk Drive</b>	<b>Available:</b> 60 or 80 GB <sup>2</sup> 4200 RPMs
<b>Standard RAM</b>	<b>Available:</b> 512 MB or 1 GB <sup>3</sup> (max. 1 GB) (PC2100 DDR SDRAM)
<b>Display (LCD)</b>	14.1" SXGA+ TFT (1400 x 1050 resolution)
<b>Graphics</b>	ATI MOBILITY™ RADEON™ POWERplay™ with 16 MB video DDR SDRAM
<b>Sound Capabilities</b>	Windows® sound system compatible Integrated stereo speakers
<b>CD-RW/DVD Combo Drive (on selected models)</b>	24x max. CD/CD-RW reading speed 8x max. DVD-ROM reading speed 4x max. DVD±R/DVD±RW reading speed 24x max. CD-R writing speed 10x max. CD-RW writing speed
<b>DVD-RW Drive (on selected models)</b>	24x max. CD reading speed 12x max. CD-RW reading speed 8x max. DVD-ROM reading speed 4x max. DVD±R/DVD±RW reading speed 16x max. CD-R writing speed 8x max. CD-RW writing speed 2x max. DVD-R/DVD-RW writing speed
<b>Modem</b>	V.90 data/fax modem <sup>4</sup>
<b>Wireless LAN Communication</b>	Intel® PRO/Wireless 2100 Network Connection with Mini PCI and IEEE 802.11b/g technology Max. 11 Mbps data transfer speed <sup>5</sup> (802.11b) (approximation) Max. 54 Mbps data transfer speed (802.11g) (approximation) Max. 100 meter communication distance <sup>6</sup> (approximation) 2.4 GHz band frequency
<b>Expansion Capabilities</b>	One PC Card slot that support Type I or II PC Cards, with CardBus support
<b>Built-in Capabilities</b>	Stereo speakers Touch pad Memory Stick® media slot <sup>7</sup>

## Standard Features (Continued)

Feature	Description
<b>Connection Capabilities</b>	Modem line jack (RJ-11) i.LINK® <sup>8</sup> S400 port (4-pin) 10BASE-T/100BASE-TX Ethernet port (RJ-45) USB 2.0 ports <sup>9</sup> (2) Printer port Microphone jack Headphones jack Monitor port (VGA) Port replicator connector
<b>Supplied Accessories</b>	Rechargeable Lithium-ion battery AC adapter and power cord
<b>Power Source</b>	16V DC/AC 100-240V
<b>Power Management</b>	Energy Star® compliant Advanced Configuration and Power Interface (ACPI)
<b>Dimensions (approximate)</b>	12.4" (w) x .9" <sup>10</sup> (h) x 9.7" (d) 316 mm (w) x 23.8 mm (h) x 247.4 mm (d)
<b>Weight (approximate)</b>	4.7 lbs. (2.1 Kg) with standard battery
<b>Operating Temperature</b>	40° F to 95° F (5° C to 35° C)
<b>Operating Humidity</b>	20% to 80% (not condensed), provided that humidity is less than 65% at 95° F (35° C), hygrometer reading of less than 84° F (29° C)
<b>Storage Temperature</b>	-4° F to 140° F (-20° C to 60° C) temperature gradient less than 18° F (-10° C) per hour
<b>Storage Humidity</b>	10% to 90% (not condensed), provided that humidity is less than 20% at 140° F (60° C), hygrometer reading of less than 95° F (35° C)

1 GHz denotes microprocessor internal clock speed; other factors may affect application performance.

2 GB means 1 billion bytes when referring to hard disk drive capacity. Accessible capacity may vary. A portion of hard disk space is reserved as a recovery partition.

3 One GB is equal to 1,024 MB.

4 Maximum speed for faxing is 14.4 Kbps. Your modem is capable of downloading at 56 Kbps using V.90. Your online service or Internet Service Provider may not support this technology or operate at this speed.

5 Maximum data communication/transfer speed per IEEE 802.11b and 802.11g standards. Speed and communication distance will be reduced under certain operating and environmental conditions.

6 Communication distance will be reduced under certain operating and environmental conditions.

7 Supports Memory Stick Pro™ high-capacity media. Tested to support up to 1 GB media capacity, does not support access control security function, such as MagicGate copyright protection in Memory Stick Pro media.

8 i.LINK is a trademark of Sony used to designate that a product contains an IEEE 1394 connection. The i.LINK connection may vary, depending on the software applications, operating system, and compatible i.LINK devices. All products with an i.LINK connection may not communicate with each other. Please refer to the documentation that came with your compatible i.LINK device for information on operating conditions and proper connection. Before connecting compatible i.LINK PC peripherals to your system, such as a CD-RW or hard disk drive, confirm their operating system compatibility and required operating conditions.

9 Supports high, full, and low speeds.

10 Height measured at the thinnest point.

## Available Configurations

<i>Model Name</i>	<i>Processor Speed</i>	<i>Screen</i>	<i>Memory</i>	<i>HDD</i>	<i>Optical Drive</i>	<i>Integrated Wireless Networking</i>	<i>Operating System</i>
<b>PCG-Z1WAMP1</b>	Intel® Pentium® M Processor 1.70 GHz <sup>1</sup>	14.1" SXGA+	512 MB (512 x 1) (max. 1 GB)	60 GB <sup>2</sup>	CD-RW/DVD combo drive	802.11b/g	Microsoft® Windows® XP Professional
<b>PCG-Z1WAMP2</b>	Intel® Pentium® M Processor 1.70 GHz	14.1" SXGA+	1,024 MB (512 x 2)	60 GB	CD-RW/DVD combo drive	802.11b/g	Microsoft® Windows® XP Professional
<b>PCG-Z1WAMP3</b>	Intel® Pentium® M Processor 1.70 GHz	14.1" SXGA+	1,024 MB (512 x 2)	80 GB	DVD-RW drive	802.11b/g	Microsoft® Windows® XP Professional

1 Processor speed will be reduced under certain operating conditions. GHz denotes microprocessor internal clock speed; other factors may affect application performance.

2 GB means 1 billion bytes when referring to hard disk drive capacity. A portion of hard disk space is reserved as a recovery partition. Accessible capacity may vary.

## Options

<i>Option<sup>1</sup></i>	<i>Description</i>	<i>Model</i>
<b>Memory</b>	256 MB memory upgrade (open slot) 512 MB memory upgrade (open slot) Use PC2100 DDR SDRAM only	
<b>Monitors</b>	A Sony VAIO® monitor or Sony LCD projector may be connected as an external display. Display cable(s) required	
<b>Drives</b>	External DVD±RW drive External USB floppy disk drive	PCGA-DDRW1 PCGA-UFD5
<b>i.LINK® (IEEE 1394) Devices<sup>2</sup></b>	Only compatible i.LINK devices may be connected, using the following i.LINK cables: 1.5-meter, 4-pin connector 1.5-meter, 4-pin connector to 6-pin connector 3.5-meter, 4-pin connector	VMC-IL4415A VMC-IL4615A VMC-IL4435A
<b>Accessories</b>	Port replicator Sony USB keyboard Sony USB optical mouse Sony USB optical mobile mouse	PCGA-PRZ1 PCGA-UKB1 PCGA-UMS5 PCG-UMS3/V or PCG-UMS3/S
<b>Memory Stick® Media<sup>3</sup></b>	32 MB 64 MB 128 MB	MSA-32A MSA-64A MSA-128A
<b>Multimedia</b>	External speakers USB Visual Communication Camera Sony Digital Handycam® camcorder Sony digital still camera Sony projector External microphone or other audio device	PCGA-SP1 PCGA-UVC10
<b>Wireless Connectivity</b>	802.11g Wireless LAN Router Access Point 802.11g Wireless LAN PC Card 802.11g Wireless Ethernet Converter 802.11a Wireless LAN Access Point 802.11a Wireless LAN PC Card 802.11a/11b Dual PC Card USB Bluetooth™ Adapter	PCWA-AR300 PCWA-AR300S PCWA-DE30 PCWA-A500 PCWA-C500 PCWA-C700 PCGA-BA1/A
<b>Other Connectivity</b>	Personal Digital Assistant (PDA) or Sony CLIE™ handheld device	
<b>Power</b>	AC adapter Standard lithium-ion battery Double-capacity battery	PCGA-AC16V6 PCGA-BP2V PCGA-BP4V

<i>Option<sup>1</sup></i>	<i>Description</i>	<i>Model</i>
<b>Carrying Cases</b>	VAIO® Large Carrying Case This custom case holds your computer, AC adapter, extra battery, and more. Keep all of the important documents within easy reach.	PCGA-CCGX
	VAIO® Notebook Backpack Ergonomically designed backpack with padded shoulder straps and ribbed contour padding on the back for maximum comfort.	PCGA-CCP1
	VAIO® Sport Backpack Stylish, convenient, and comfortable backpack with efficient storage for PC and accessories.	PCGA-CCP2
	VAIO® Notebook & AC Adapter Cases (neoprene) Protect your PC from spills, nicks, and scratches.	PCGA-CCN1

- 1 The computer industry lacks standards, and therefore, there are a multitude of varying software packages and add-on hardware options. This product is not manufactured to work with any specific software, and Sony does not and cannot make any warranty or representation with respect to the performance of this product with any particular software packages and/or non-Sony add-on hardware option except those mentioned here. Sony hereby disclaims any representations or warranties that this product is compatible with any combination of non-Sony products you may choose to connect to it. While Sony representatives or Sony authorized dealers may be able to assist you and may make recommendations, they are NOT authorized to vary or waive this disclaimer. Purchasers must determine for themselves the suitability and compatibility of the hardware and software in each and every particular instance.
- 2 i.LINK is a trademark of Sony used only to designate that a product contains an IEEE 1394 connection. The i.LINK connection may vary, depending on the software applications, operating system, and compatible i.LINK devices. All products with an i.LINK connection may not communicate with each other. Refer to the documentation that came with your compatible i.LINK device for information on operating conditions and proper connection. Before connecting compatible i.LINK PC peripherals to your system, such as an optical disc drive or hard disk drive, confirm their operating system compatibility and required operating conditions.
- 3 Data storage capacity may vary as a portion of the memory is used for data management functions. Supports Memory Stick Pro™ high-capacity media. Tested to support up to 1 GB media capacity, does not support high-speed transfer, does not support access control security function, does (or does not) support MagicGate copyright protection in Memory Stick Pro media.

## **Memory and Storage**

<i>Item</i>	<i>Description</i>
<b>L2 Cache Memory</b>	1 MB (CPU Integrated)
<b>Hard Disk Drive</b>	60 or 80 GB <sup>1</sup> 4200 RPMs
<b>Standard RAM</b>	Available: 512 MB or 1 GB <sup>2</sup> (max. 1 GB) (PC2100 DDR SDRAM)

1 GB means 1 billion bytes when referring to hard disk drive capacity. A portion of hard disk space is reserved as a recovery partition. Accessible capacity may vary.

2 1 GB is equal to 1,024 MB.

## **Typical Expansion Memory Configuration**

The amount of memory installed on your computer may vary, depending on the model you purchased.

<i>Total System Memory (MB)</i>	<i>Slot 1 (MB)</i>	<i>Slot 2 (MB)</i>
512	512	0
1,024	512	512



## Software

Your computer may not be supplied with all of the software discussed in this section, depending on the computer model you purchased. To view information about the specific software preinstalled on your computer, see the software program's online Help.

<i>Application</i>	<i>Description</i>
<b>America Online®</b> <b>(Broadband or Dial-Up)<sup>1</sup></b> <i>America Online, Inc.</i>	America Online is a popular Internet online service. Stay in touch with family and friends with easy-to-use e-mail. Manage your personal finances, get the latest news and sports scores, and chat with thousands of others who share your interests.
<b>DVgate™ Plus</b> <i>Sony Electronics Inc.</i>	Connect a compatible digital video camera to your computer's i.LINK® port and capture video clips and still images. Edit clips from your video, add new clips, and combine clips into new movie segments. Save your movies back to your digital video came or in a variety of popular file formats.
<b>Microsoft® Money Standard<sup>2</sup></b> <i>Microsoft Corp.</i>	Microsoft Money 2003 Standard provides a quick and easy way to organize and manage your personal finances. New features include auto-balancing, a bills estimator, spending comparison reports, and investment reminders. Save time organizing and managing your cash flow and balancing your checkbook. Create and track a budget, pay your bills, organize your finances, and view a complete picture of your financial health all in one place.
<b>Microsoft® Works</b> <i>Microsoft Corp.</i>	Works lets you quickly and easily create high-quality, fun documents. Works provides the core tools you need to create documents, manage lists and schedules, create reports and budgets and organize information from many sources. Works includes Word Processor, Works Database, Works Spreadsheet, Works Portfolio, and Works Calendar.
<b>Network Smart Capture</b> <i>Sony Electronics Inc.</i>	Network Smart Capture captures images and video from any Sony Digital Camcorder that supports a standard i.LINK connection. Send your video or still images through e-mail or upload them to the ImageStation(SM) service. You can use the Web camera function to automatically upload your captured images.
<b>Norton Internet Security™<sup>2</sup></b> <i>Symantec Corporation</i>	Symantec's Norton Internet Security™ provides essential protection from viruses, hackers, and privacy threats. This easy-to-use, integrated suite includes full versions of Norton AntiVirus and Norton Personal Firewall to defend your PC against the most common Internet dangers. Norton Internet Security also includes Norton Spam Alert, which helps you detect and filter unwanted e-mail. Norton Parental Control keeps your children safe by letting you block objectionable Web sites and set up separate Internet access privileges for each member of your household. Automatic downloads keep Norton Internet Security updated against new security threats. This is a trial version of the Norton Internet Security.
<b>PictureGear Studio™</b> <i>Sony Electronics Inc.</i>	PictureGear Studio still image management software displays still images from your hard drive or a Sony digital still camera. The still images appear in a convenient light-table format so that you can easily view the contents of an entire folder, create your own photo albums and make prints.
<b>RealOne™ Player</b> <i>RealNetworks, Inc.</i>	RealOne™ Player is an all-in-one digital media player that lets you find everything and play anything. RealOne Player fuses a streaming media player, jukebox, browser and new content discovery services all in one application. Play CDs, MP3s and internet radio stations from anywhere in the world. View video clips and movies with the same player. Download music directly to your Sony MiniDisc™ Walkman or your Sony Memory Stick™ Walkman.
<b>SonicStage™</b> <i>Sony Electronics Inc.</i>	The SonicStage jukebox application gives you all the tools you need to manage music on your computer. SonicStage software sports high-quality digital audio storage, a music visualizer, a sleek player skin design, audio CD burning capability (on computer models that include a CD recording device), and a parametric equalizer for fine-tuning audio playback.

## **Software (Continued)**

Your computer may not be supplied with all of the software discussed in this section, depending on the computer model you purchased. To view information about the specific software preinstalled on your computer, see the software program's online Help.

<i><b>Application</b></i>	<i><b>Description</b></i>
<b>VAIO Media™</b> <i>Sony Electronics Inc.</i>	VAIO Media™ software brings multimedia to your network, enabling you to share music, video, and still image files between your VAIO computers. You can set up one or more computers as “media servers,” which store your multimedia files and make them available to other VAIO computers on your wired or wireless network.
<b>VAIO Support Agent</b> <i>Sony Electronics Inc.</i>	VAIO Support Agent provides immediate, interactive online support with information about your preinstalled software and answers to frequently asked questions.
<b>WinDVD for VAIO®</b> <i>InterVideo, Inc.</i>	WinDVD is a simple-to-use DVD player that offers all the features you would expect to find in a standard consumer DVD player, including advanced display and navigation features such as zoom, pan, bookmark, and time search.

1 Requires a fee for use.

2 Certain features are time limited.

### ***To Contact Sony***

Visit the Sony VAIO® B2B Web site at: [www.sony.com/VAIOB2B](http://www.sony.com/VAIOB2B)

SONY ELECTRONICS INC. PROVIDES NO WARRANTY WITH REGARD TO THIS DOCUMENT, AND HEREBY EXPRESSLY DISCLAIMS ANY IMPLIED WARRANTIES OF MERCHANTABILITY OR FITNESS FOR ANY PARTICULAR PURPOSE WITH REGARD TO SONY COMPUTER PRODUCTS. IN NO EVENT SHALL SONY ELECTRONICS INC. BE LIABLE FOR ANY INCIDENTAL, CONSEQUENTIAL, OR SPECIAL DAMAGES, WHETHER BASED ON TORT, CONTRACT, OR OTHERWISE, ARISING OUT OF OR IN CONNECTION WITH THIS DOCUMENT, THE SOFTWARE, OR OTHER INFORMATION CONTAINED HEREIN OR THE USE THEREOF.

Sony Electronics Inc. reserves the right to make any modification to this document or the information contained herein at any time without notice. The software on devices described herein is governed by the terms of separate agreements.

Updates and additions to software may require an additional charge. Subscriptions to online service providers may require a fee and credit card information. Financial services may require prior arrangements with participating financial institutions.

Certain software product(s) included with this computer may include features such as copy protection and content management technology. USE OF THE SOFTWARE PRODUCT(S) REQUIRES AGREEMENT TO APPLICABLE END USER AGREEMENTS AND FULL COMPLIANCE WITH APPLICABLE PRODUCT ACTIVATION PROCEDURES. Product activation procedures and privacy policies will be detailed during initial launch of the software product(s), or upon certain reinstallations of the software product(s) or reconfigurations of the computer, and may be completed by Internet or telephone (toll charges may apply).

© 2004 Sony Electronics Inc. Reproduction in whole or in part without written permission is prohibited. All rights reserved. Sony, VAIO, the VAIO logo, VAIO Media, DVgate Plus, Handycam, PictureGear, i.LINK, MagicGate, Memory Stick, Mavica, CLIE, SonicStage, and Click to DVD are trademarks of Sony. Microsoft and Windows are trademarks or registered trademarks of the Microsoft Corporation. All other trademarks are trademarks or registered trademarks of their respective owners.