

**SONY®**

CORDLESS TELEPHONE

**SPP-100**

## OPERATING INSTRUCTIONS

Before operating the unit, please read this manual thoroughly, and retain it for future reference.

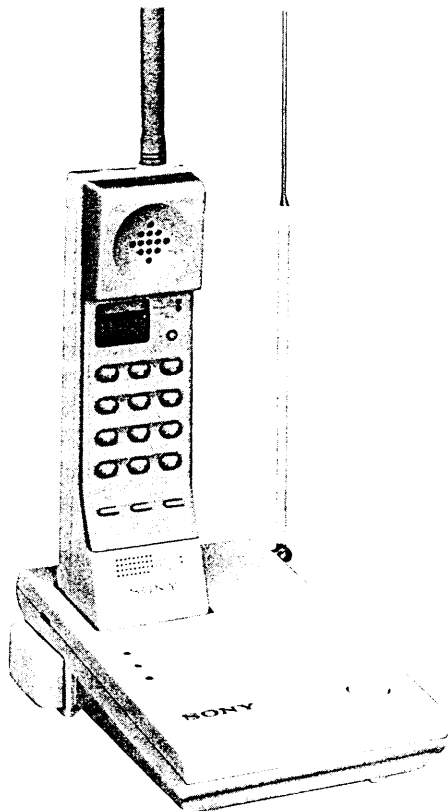

## OWNER'S RECORD

The model and serial numbers are located at the bottom of the base unit and handset.

Record the serial number in the space provided below. Refer to these numbers whenever you call upon your Sony dealer regarding the system.

Model No. SPP-100

Serial No. \_\_\_\_\_

## TABLE OF CONTENTS

Features .....	2
Precautions .....	2
Warning and other important notices .....	2
Location and function of parts and controls .....	4

### Preparation

Telephone line connection .....	6
Power connection .....	6
Dialing mode selector setting .....	6
Battery recharging .....	7

### Operation

Making an outgoing call .....	8
Function selector setting .....	8
If you have entered an incorrect number .....	9
If the line is busy .....	9
If you hear interference noise .....	9
Accessing alternate long distance services .....	10
Signalling the handset from the base unit .....	10
Answering an incoming call .....	11
Specifications .....	Back cover
Troubleshooting guide .....	Back cover

## FEATURES

- Preset security code, assigned from one million various codes, prevents unauthorized capturing of your line by third parties.
- 10-channel MCA (Multi Channel Access) system automatically selects vacant channels.
- Two detachable Ni-Cd batteries eliminate the waiting time for battery recharging.
- Pulse or tone dial switchable.

## PRECAUTIONS

- **Before the initial use**, insert one of the two supplied battery packs into the battery compartment of the base unit and charge it for 6 hours.  
(For details, see page 7.)
- Operate the AC power adaptor on 120 V ac, 60 Hz.
- Unplug the AC power adaptor from the wall outlet when the cordless telephone system is not to be used for an extended period of time. To disconnect the cord, pull it out by grasping the plug. Never pull it by the cord.
- Do not install the base unit in a location near a heat source such as radiators or airducts, or in a place subject to direct sunlight, excessive dust, moisture, rain, mechanical vibration, or shock.
- Do not place the units on or near a TV set or a personal computer.  
The units may interfere with each other.
- Should any liquid or solid object fall into the base unit, unplug the unit and have it checked by qualified personnel before operating the unit any further.
- Keep spring-wound watches and personal credit cards using a magnetic coding away from the unit to prevent their being damaged by the strong magnet installed between the mini-charge terminals on the base unit.
- This unit is designed and approved for single party lines only. It should not be connected to multiple lines or a coin telephone.

If you have any question or problem concerning your set that is not covered in this manual, please consult the nearest Sony Service Station authorized to service telephone terminal equipment.

## WARNING

**To prevent fire or shock hazard, do not expose the set to rain or moisture.**

**To avoid electrical shock, do not open the cabinet. Refer servicing to qualified personnel only.**

### INFORMATION

This equipment generates and uses radio frequency energy and if not installed and used properly, that is, in strict accordance with the manufacturer's instructions, may cause interference to radio and television reception. It has been type tested and found to comply with the limits for a Class B computing device in accordance with the specifications in Subpart J of Part 15 of FCC Rules, which are designed to provide reasonable protection against such interference in a residential installation.

However, there is no guarantee that interference will not occur in a particular installation. If this equipment does cause interference to radio or television reception, which can be determined by turning the equipment off and on, the user is encouraged to try to correct the interference by one or more of the following measures:

- reorient the receiving antenna
- relocate the equipment with respect to the receiver
- move the equipment away from the receiver
- plug the equipment into a different outlet so that equipment and receiver are on different branch circuits.

If necessary, the user should consult the dealer or an experienced radio/television technician for additional suggestions. The user may find the following booklet prepared by the Federal Communications Commission helpful:

“How to Identify and Resolve Radio-TV Interference Problems”.

This booklet is available from the U.S. Government Printing Office, Washington, DC 20402, Stock No. 004-000-00345-4.

## SERVICE REQUIREMENTS

If the cordless telephone should malfunction, all repairs will be performed by an authorized Sony Service Station. This unit has been registered within the FCC for direct connection to the telephone network. Under the FCC program, no customer is authorized to repair this unit. This applies to a unit both in and out of warranty. If an

unauthorized repair is performed, the registration of the unit for direct connection to the network will be null and void. If the unit is still in warranty, the remainder of the warranty period will also be null and void. It is the responsibility of users requiring service to report the need for service to their Sony dealer.

## IMPORTANT INSTRUCTIONS TO USERS

Your cordless telephone system has been approved by the Federal Communications Commission (FCC) as not being harmful to the telephone network when connected directly to the telephone lines. In order to fully comply with the Rules of the FCC, the following instructions should be read carefully and followed completely where applicable:

- 1 The FCC rules require that all direct connections to the telephone lines must be made through standard plugs and jacks.  
No connection can be made to party lines or coin lines. Prior to connecting your device to the lines, you must:
  - a) Call your local telephone company and inform them that you have an FCC registered device which you wish to connect to their lines. Give them the 14 digit FCC Registration Number and Ringer Equivalent Number, both of which are on a label located on an outer surface of the device.
  - b) After the telephone company has installed the jack, you can connect your cordless telephone system by inserting the mating plug of your equipment into this jack.
  - c) All repairs must be accomplished as described in "SERVICE REQUIREMENTS".

- 2 If it appears that your cordless telephone system is malfunctioning, it should be disconnected from the telephone line until it can be determined whether your cordless telephone system is the source of the trouble or not. If your machine needs repair, it should not be reconnected until such repairs have been made.
- 3 If harm does occur, the telephone company shall, where practicable, notify you, the customer, that temporary discontinuance of service may be required; however, where prior notice is not practicable, the telephone company may temporarily discontinue service forthwith, if such action is reasonable in circumstances. In case of such temporary discontinuance, the telephone company shall (1) promptly notify you, the customer, of such temporary discontinuance (2) afford you, the customer, the opportunity to correct the situation which gave rise to the temporary discontinuance, and (3) inform you, the customer, of your right to bring a complaint to the Commission pursuant to the procedures set forth in the Rules.  
Procedures for filing the complaints can be obtained from your local dealer, or if necessary, by writing directly to the manufacturer.

## IMPORTANT NOTICE

This telephone does not provide magnetic coupling to hearing aid and is prohibited for use by FCC rules in the following locations:

- 1 Places where a person with impaired hearing might be isolated, such as elevators, highways, tunnels, etc.
- 2 Hospital rooms, residential health care facilities, convalescent homes, and prisons, specifically where telephones are used for signalling lifethreatening or emergency situation if alternative means of signalling are not available.
- 3 Places where telephones are specifically installed to alert emergency authorities such as police, fire or medical assistance personnel.

- 4 Workstations for hearing impaired employees.
- 5 Places in which visits by public are reasonably expected, such as lobbies of hotels, motels, apartment buildings, public transportation terminals, stores, etc.
- 6 Hotels and motels where fewer than ten percent of the rooms contain hearing-aid compatible telephones or contain no jack for plug-in hearing-aid compatible telephones.

**Warning:** This telephone operates as a radio transmitter. Conversations over this cordless telephone may be heard by others on radios within the area of its range of transmission.

# LOCATION AND FUNCTION OF PARTS AND CONTROLS

For further details, refer to the page numbers next to each item.

## Base unit

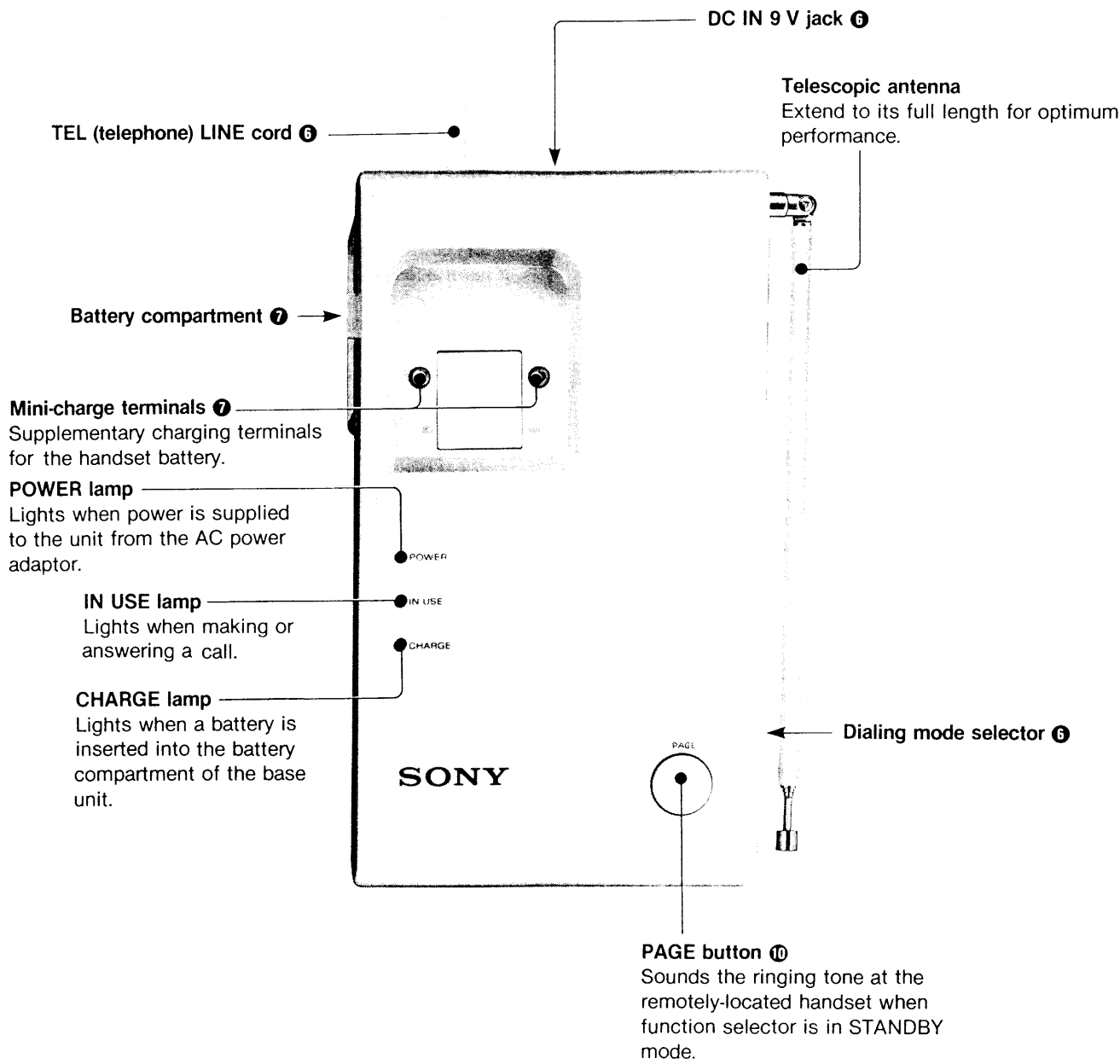

Handset

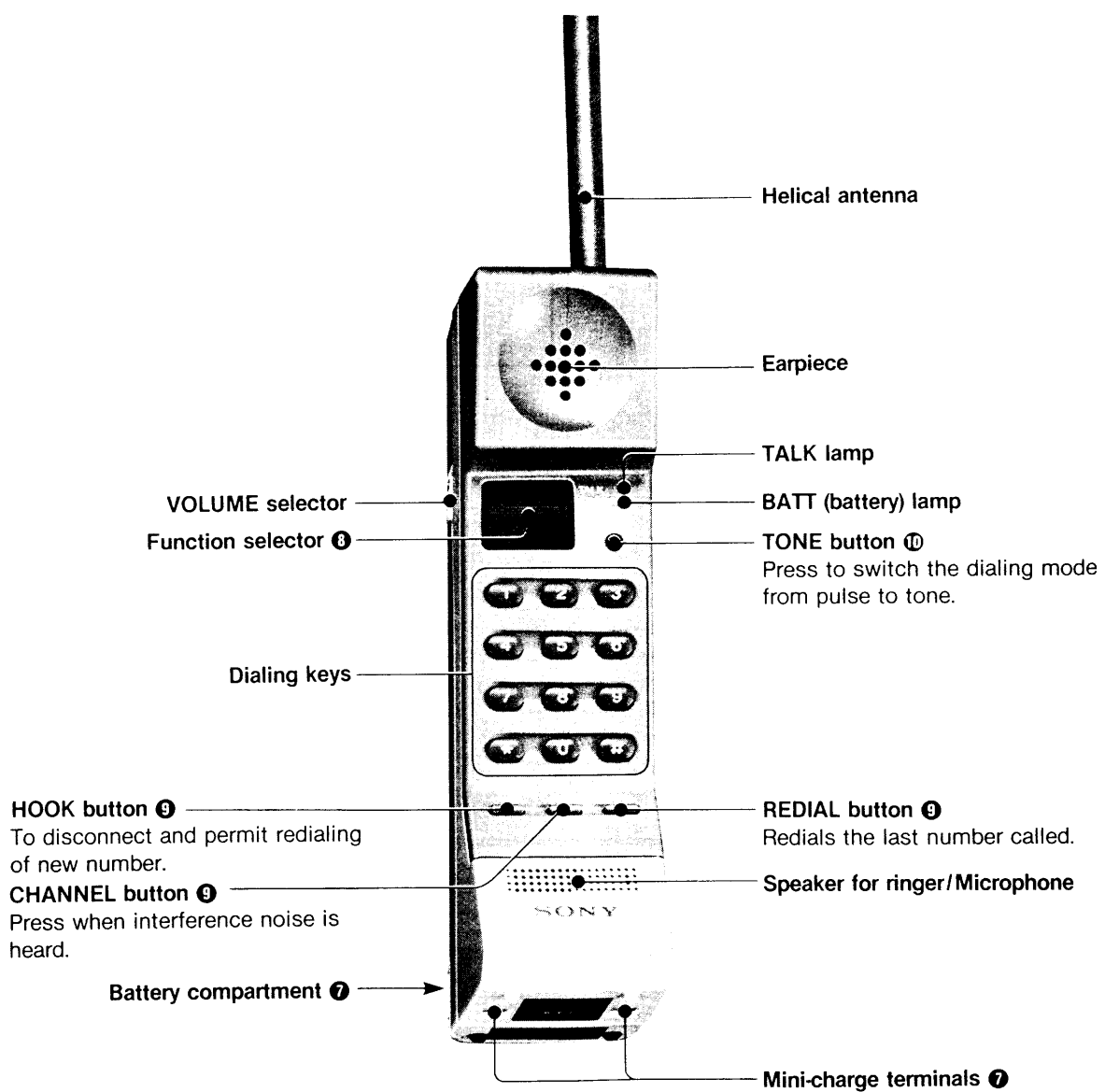

# PREPARATION

## TELEPHONE LINE CONNECTION

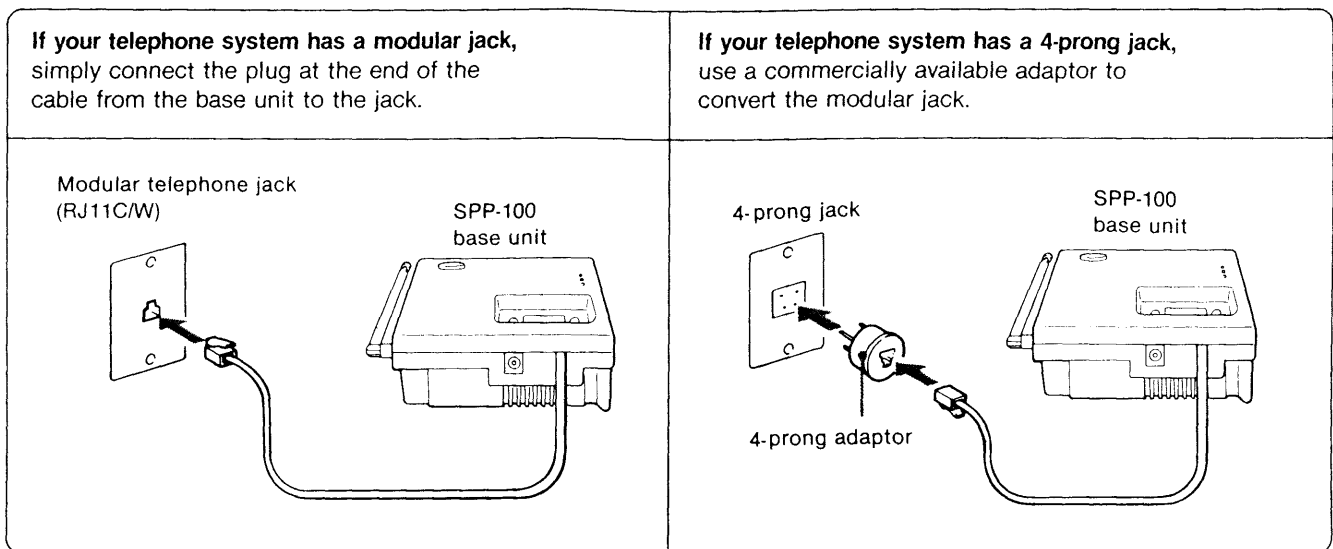

## POWER CONNECTION

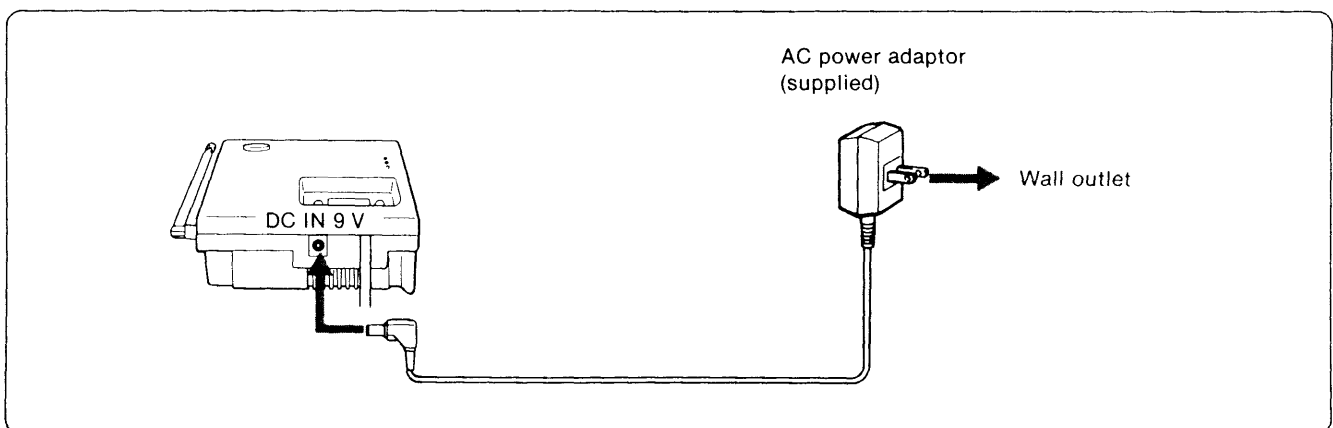

## DIALING MODE SELECTOR SETTING

After installing telephone, be sure to set the dialing mode selector on the base unit to 10, 20, or T, whichever is appropriate to your telephone line.

If necessary, contact your local telephone company to determine if you have:

- a tone type line,
- a 10 pulse per second rotary dial line, or
- a 20 pulse per second rotary dial line.

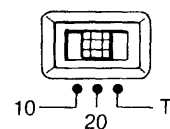
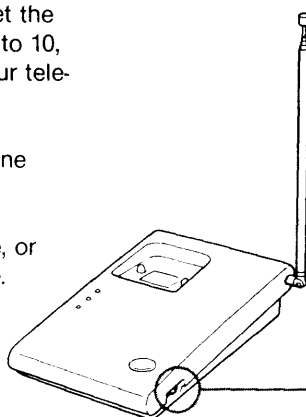

10 (10 pps \*) } For pulse dial phone  
20 (20 pps \*) }  
T (tone): For tone type phone

\*PPS = pulse per second

# BATTERY CHARGING

Before the initial use, charge one of the two supplied battery pack.

- 1 Insert a battery pack into the battery compartment of the base unit and charge it for 6 hours.
- 2 Remove it and insert into the battery compartment of the handset.
- 3 Insert the other battery pack into the base unit so that you can charge it while using your SPP-100.

Your SPP-100 is now ready for use.

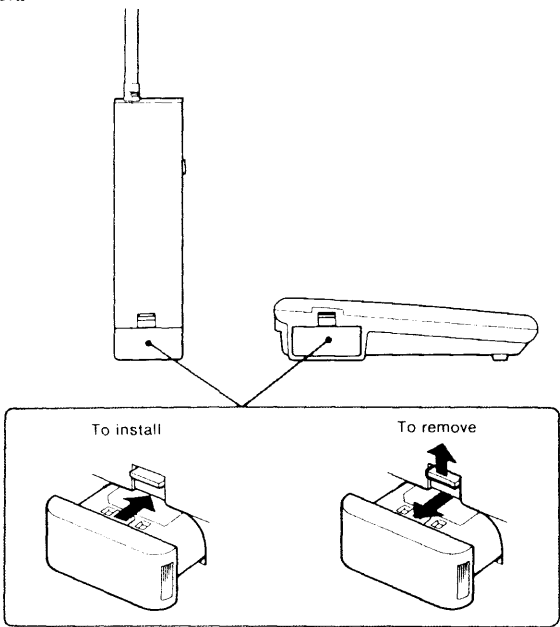

## Notes

- The battery compartment of the base unit is equipped with the rapid charging system controlled by a microcomputer. The battery pack inserted to the battery compartment receives a full charge in 6 hours. Once the battery is fully charged, consumption of current, due to natural discharge, is restored by a compensating charge.
- The battery pack in the handset receives only a minimal charge from the mini-charge terminals when

the handset is on the base unit (just enough to compensate for STANDBY usage). You can prevent the handset battery from being exhausted frequently or overcharged.

- The battery packs should be rotated from the handset to the base unit and from the base unit to the handset when the battery in the handset is exhausted. This will insure longest battery life and dependable performance.

## If the handset battery becomes weak

- **When talking on the phone**, the BATT lamp will go off and the handset will beep. After a minute the call will be disconnected.
- **When the function selector is set to STANDBY**, the BATT lamp will go off with no beep.

If either one of the above happens, replace the handset battery with the fully charged one in the base unit.

## Note

After replacing the handset battery, set the function selector to STANDBY for a few seconds to initiate normal operation, then move the function selector to the desired setting.

## In case of power interruption

- The base unit battery works as a back-up battery in case of power interruption so that you can operate the telephone without interruption. The back-up battery, if fully charged, lasts about 4 hours in the STANDBY mode.
- If you do not need to operate the telephone during power interruption, you may remove the battery from the base unit to conserve the battery.
- If someone is trying to call you, you will not hear any ring signal if the base unit battery is removed, unless you have another functioning telephone plugged into your telephone line.

Before operation, complete the PREPARATION on pages 6—7.

**Note**

This model is equipped with a 10-channel MCA (Multi Channel Access) system. Each time you make an outgoing call or answer an incoming call, the handset and the base unit search for a clear channel among ten and

verify the security code, assigned from 1,000,000 various codes.  
Making line connections may take a few seconds because of this search and verification process.

**MAKING AN OUTGOING CALL**

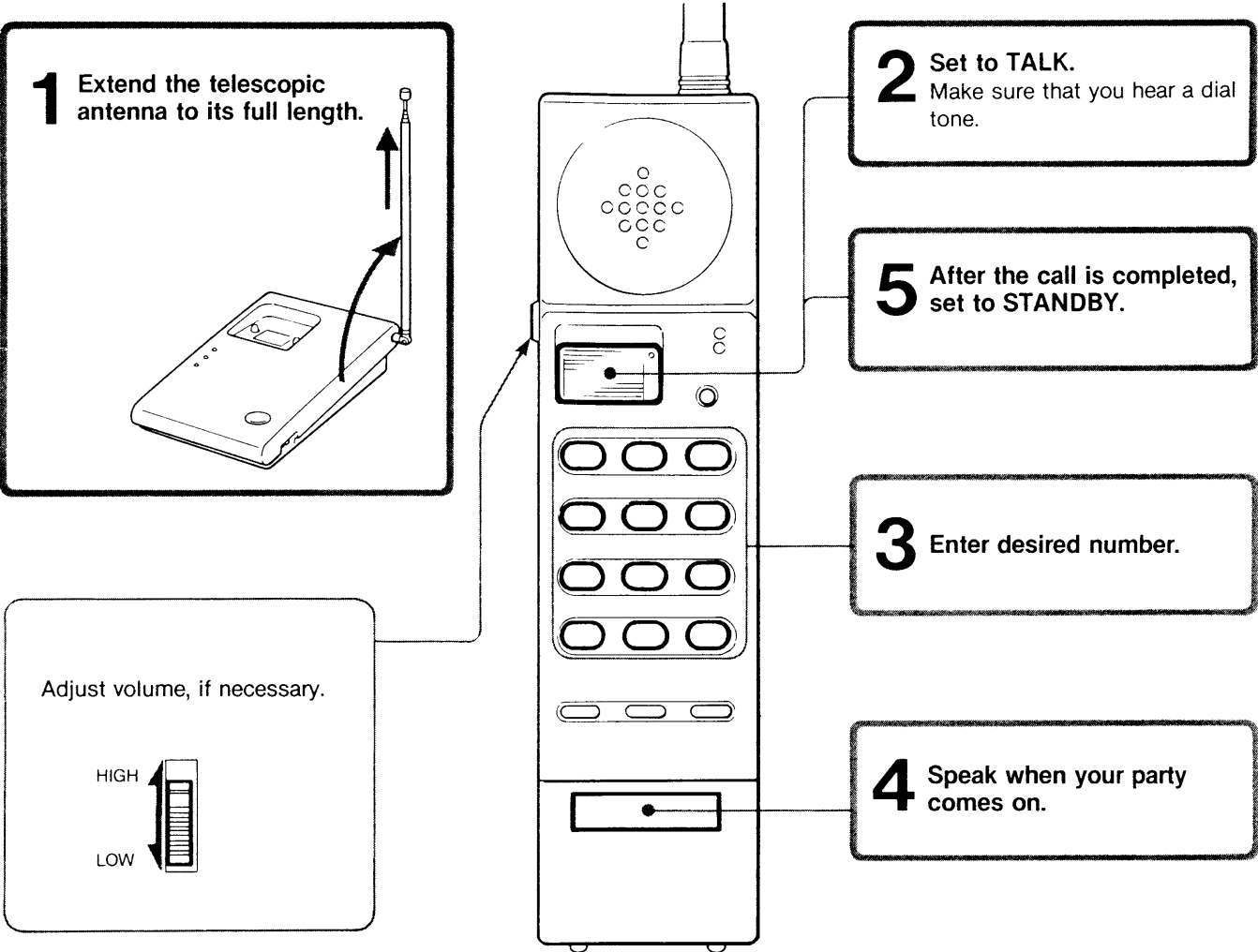

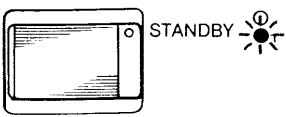
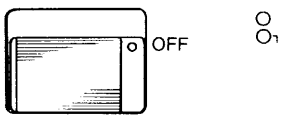
Function selector setting		
 <p>To make an outgoing call or to reply to an incoming call. (No incoming calls accepted while in the TALK position.)</p>	 <p>Normal position</p>	 <p>Handset power is off. (No incoming calls accepted.)</p>



**If you have entered an incorrect number**

**1** Press the HOOK button to disconnect.

**Note**  
The HOOK button can also be used to terminate a telephone call.

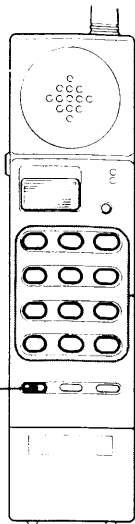

**2** Redial correct number.

**If the line is busy**

**1** Set to STANDBY and reset to TALK.

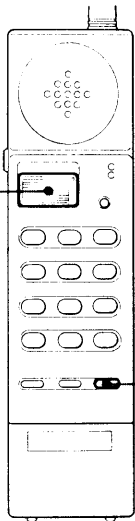

**2** Press the REDIAL button.  
The unit will redial the last number called.

- Notes**
- The unit will keep the last number called in its memory unless another number is dialed.
  - You can redial a phone number of up to 31 digits.

**If you hear interference noise**

Hold the handset close to the base unit. If the noise still persists, press the CHANNEL button on the handset so that the unit will automatically select a vacant channel.

**Note**  
The unit will interrupt the conversation for a few seconds while searching for a vacant channel.

Before keying in the telephone number or after pressing the CHANNEL button, check to see that the TALK lamp lights up with a “beep” tone.

## Accessing alternate long distance services (MCI, SPRINT, etc.)

When dialing mode of the base unit is set to T (tone)

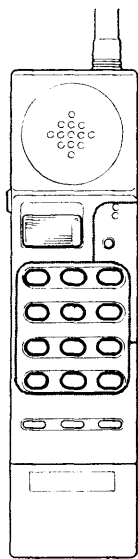

- 1** Enter local access number (654-3210). Make sure that you hear a dial tone.
- 2** Enter authorization number (9876543), then long distance number 123-456-7890.

Redialing function is not available.

Ex. Local access telephone no. : 654-3210  
Authorization no. : 9876543  
Long-distance no. : 123-456-7890

When dialing mode is set to 10 or 20 (pulse)

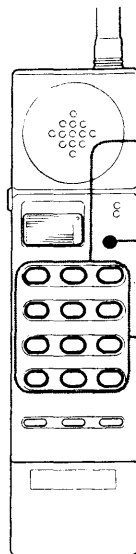

- 1** Enter local access number (654-3210). Make sure that you hear a dial tone.
- 2** Press TONE button.
- 3** Enter authorization number (9876543), then long distance number (123-456-7890).

### If the line is busy

- 1** Set the function selector to STANDBY, then to TALK again.
- 2** Press REDIAL button.
- 3** After you hear a dialing tone, press REDIAL button again.

## Signalling the handset from the base unit

The handset may be signalled when the function selector on the handset is set to STANDBY and the PAGE button on the base unit is pressed.

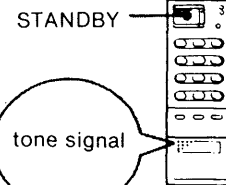
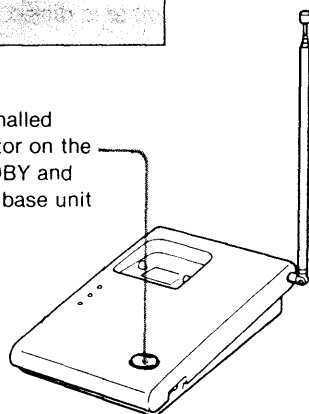

# OPERATION

## ANSWERING AN INCOMING CALL

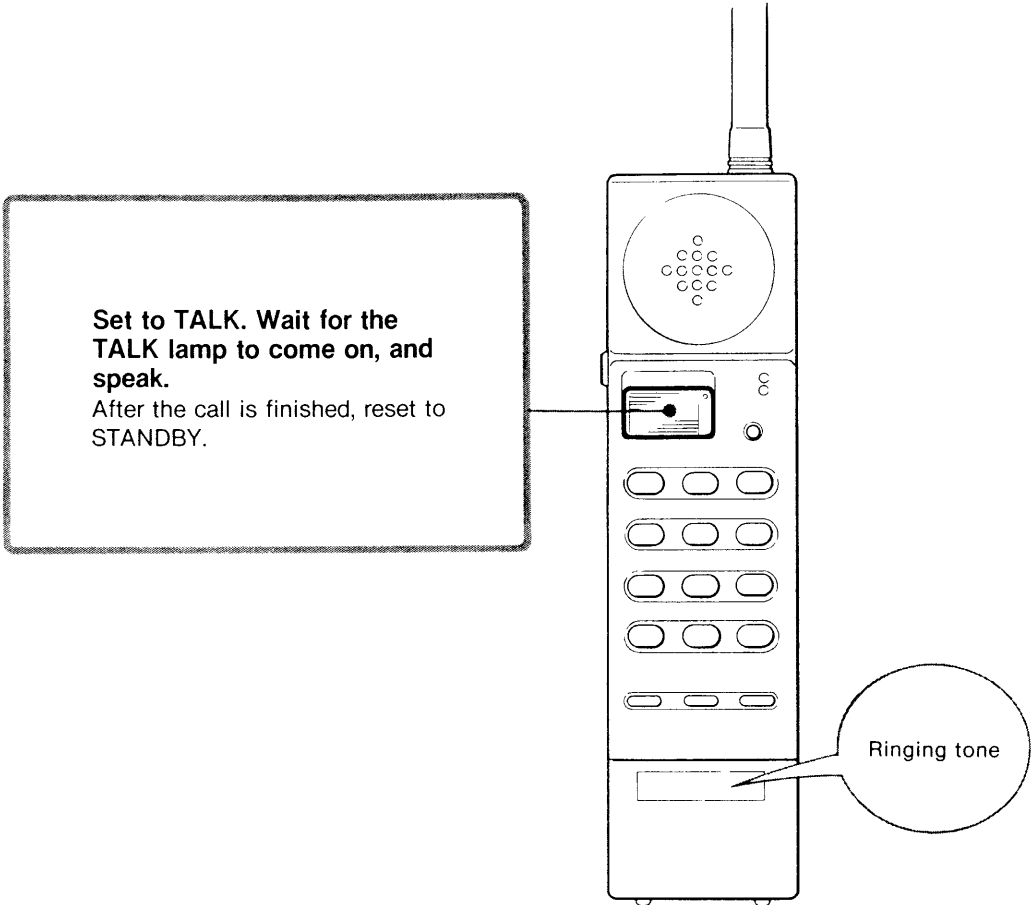

# SPECIFICATIONS

### General

Frequency control    Crystal-controlled PLL  
Operation mode        FM, duplex  
Operating frequency   46–49 MHz  
FCC Registration Number    AK896A-71452-WT-E  
Rigner Equivalence    0.5B  
Supplied accessories    Ni-Cd batteries (2)  
                                  AC power adaptor (1)

### Handset

Power source            Detachable Ni-Cd batteries  
Battery life             Standby 20 H  
                                  Talk     12 H  
Dimensions             Approx. 53 × 370 × 60 mm (w/h/d)  
                                  (2<sup>1</sup>/<sub>8</sub> × 14<sup>5</sup>/<sub>8</sub> × 2<sup>3</sup>/<sub>8</sub> inches)  
Weight                    Approx. 410 g, battery included  
                                  (14<sup>1</sup>/<sub>2</sub> oz)

### Base Unit

Power source            DC 9 V from AC power adaptor  
Power consumption    Approx. 160 mA at TALK mode  
Battery back-up duration    Approx. 4 hours at standby mode (when fully charged)  
Dimensions             Approx. 135 × 49 × 205 mm (w/h/d)  
                                  (5<sup>3</sup>/<sub>8</sub> × 2 × 8<sup>1</sup>/<sub>8</sub> inches)  
Weight                    Approx. 454 g, battery excluded  
                                  (1 lb)

Design and specifications subject to change without notice.

# TROUBLESHOOTING GUIDE

Should any problem occur with the set, make the following simple tests to determine whether or not servicing is required. If the problem persists after you have made these tests, consult the nearest Sony dealer.

Symptom	Cause
The unit does not work.	<ul style="list-style-type: none"><li>● Incorrect connection of the AC power adaptor.</li><li>● Incorrect connection of the telephone line.</li><li>● The handset battery needs to be recharged.</li><li>● The telescopic antenna is not fully extended.</li><li>● The handset function selector is set to OFF.</li><li>● The handset is too far from the base unit.</li></ul>
Interference noise over the line.	<ul style="list-style-type: none"><li>● The handset is too far from the base unit.</li><li>● Radio interference occurs from external units.</li></ul>
The TALK lamp does not light up when the function selector is set to TALK.	<ul style="list-style-type: none"><li>● The handset is too far from the base unit.</li></ul>
The handset beeps with the TALK lamp blinking when a button is pressed.	<ul style="list-style-type: none"><li>● The handset is too far from the base unit.</li><li>● Radio interference occurs from external units.</li></ul>
The BATT lamp goes off and the handset beeps for about a minute.	<ul style="list-style-type: none"><li>● The handset battery is weak.</li></ul>