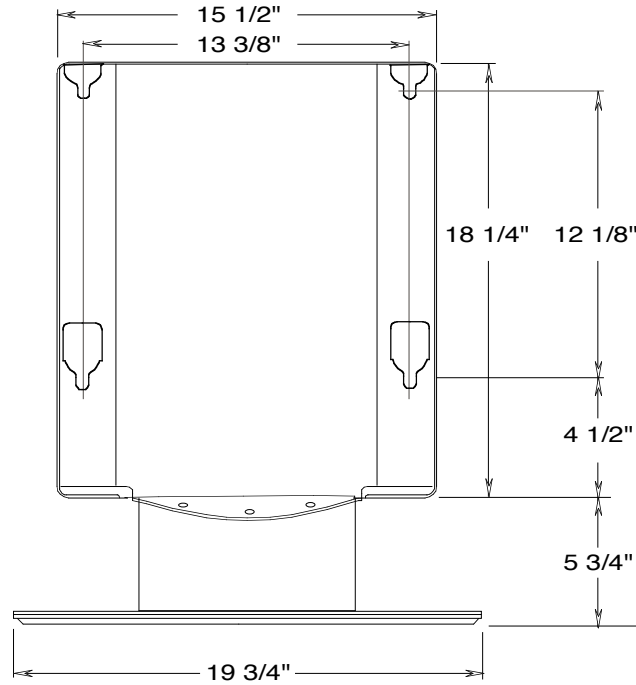
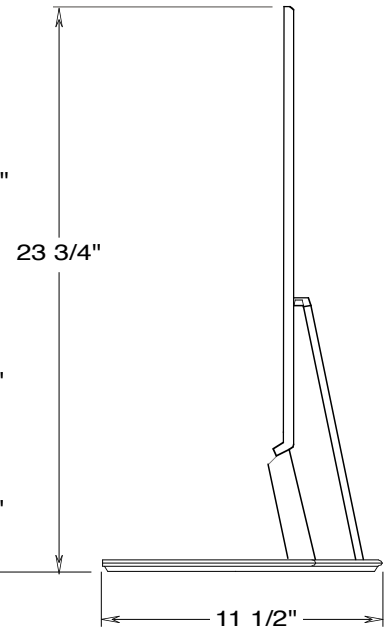
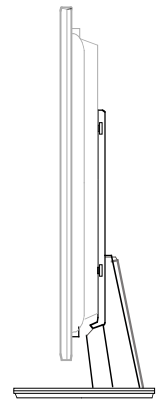
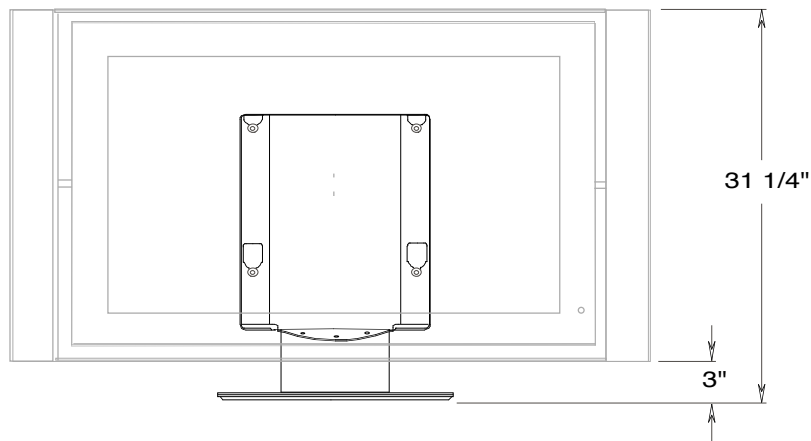

SONY**SU-P42T1**

DESCRIPTION: Plasma Table
Stand
DIMENSIONS
(WHD): 19 3/4" x 23 3/4" x 11 1/2"
WEIGHT: TBD

POWER
REQUIREMENTS: N/A
POWER
CONSUMPTION: N/A

FRONT VIEW**SIDE VIEW****KE-42XBR900**

NOTE:
WHERE THERE ARE CLOSE TOLERANCES INVOLVED IN CABINET BUILDING
OR APPLICATIONS WHICH REQUIRE A GREAT DEGREE OF PRECISION WE
RECOMMEND THAT THE PRODUCT ITSELF BE USED TO MAKE THE ACTUAL
MEASUREMENTS. SONY WILL NOT BE RESPONSIBLE FOR INACCURACIES
IN THE DESIGN OR MANUFACTURE OF ENCLOSURES .