

# aiwa

**COMPACT**  
**disc**  
DIGITAL AUDIO

**OPERATING INSTRUCTIONS  
MANUAL DE INSTRUCCIONES  
MODE D'EMPLOI**

# **ADC-WRF35 ADC-RF35 ADC-M35**

**COMPACT DISC CHANGER  
CAMBIADOR DE DISCOS COMPACTOS**

**ENGLISH**

**ESPAÑOL**

**FRANÇAIS**

## **OWNER'S RECORD**

For your convenience, record the model number and serial number (you will find them on the rear of your set) in the space provided below. Please refer to them when you contact your AIWA dealer in case of difficulty.

Model No.

Serial No.

# TABLE OF CONTENTS

FEATURES .....	2
PRECAUTIONS .....	3
UNPACKING .....	4
INSTALLATIONS .....	5
CONNECTIONS .....	9
HOW TO USE .....	12
SPECIFICATIONS .....	15

## FEATURES

- Tracks from 6 CDs stored in the disc magazine can be selected and played.
- Horizontal, vertical, slanted or suspended installation can be made.
- This system allows you to connect the compact disc changer to your car stereo that can receive FM broadcasts.

### Configuration of each system

#### ADC-WRF35

Compact disc changer, power unit & FM modulator, wired remote control and wireless remote control

#### ADC-RF35

Compact disc changer, power unit & FM modulator and wired remote control

#### ADC-M35

Compact disc changer

### NOTE

#### FOR USE IN THE U.S.A.

This equipment has been tested and found to comply with the limits for a Class B digital device, pursuant to Part 15 of the FCC Rules. These limits are designed to provide reasonable protection against harmful interference in a residential installation.

This equipment generates, uses, and can radiate radio frequency energy and, if not installed and used in accordance with the instructions, may cause harmful interference to radio communications. However, there is no guarantee that interference will not occur in a particular installation. If this equipment does cause harmful interference to radio or television reception, which can be determined by turning the equipment off and on, the user is encouraged to try to correct the interference by one or more of the following measures:

- Reorient or relocate the receiving antenna.
- Increase the separation between the equipment and receiver.
- Connect the equipment into an outlet on a circuit different from that to which the receiver is connected.
- Consult the dealer or an experienced radio/TV technician for help.

### CAUTION

Modifications or adjustments to this product, which are not expressly approved by the manufacturer, may void the user's right or authority to operate this product.

# PRECAUTIONS

- Do NOT install the unit in a location where it may be subjected to:
  - Direct sunlight or other sources of excessive heat
  - Fluid, rain or moisture
  - Excessive dirt or dust
  - Excessive vibration
- This unit is designed to be operated on a 12-volt DC negative-ground electrical system only.
- Choose the mounting location carefully so that the unit will not interfere with normal driving functions.
- Before making connections, disconnect the  $\ominus$  terminal of the car battery to avoid short circuiting.
- Be sure to connect the red power input lead to the positive 12-V power terminal, to which power is supplied when the ignition key is in the accessory position.
- The power unit & FM modulator is designed only for this ADC-M35 compact disc changer.

## Notes on CDs

- A defective or soiled disc stored in the disc magazine can cause the sound to drop out during play.
- Always handle a disc by holding its inner and outer edges.

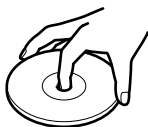

- Do NOT touch the surface of the unlabeled side of the disc.
- Do NOT attach paper or tape etc. to a disc.



- Do NOT expose the discs to direct sunlight or excessive heat.



- Clean the discs before inserting them into the disc magazine. Always clean a disc from the center outward with a cleaning cloth.



- NEVER use solvents such as benzine or alcohol to clean a disc.
- You cannot play an 8-cm (3-inch) CD — even with the specially designed adaptor.

## Notes on the disc magazine

- Do NOT leave the disc magazine in a place subject to excessive temperature or humidity.
- Do NOT insert more than one disc per slot.
- Do NOT drop the disc magazine.

## Reset buttons

The wired remote control and compact disc changer each have a reset button. The compact disc changer's reset button is visible when the disc magazine door is opened. Press either of the buttons in the following cases:

- All the connections have been completed.
- The unit malfunctions. (For example, if the unit does not load a CD properly.)
- An error code appears in the display window of the wired remote control.

When you press this button, use the tip of a ball-point pen or similar pointed object.

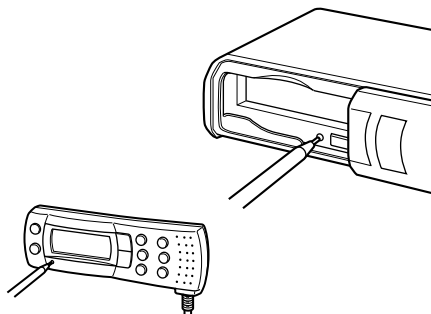

# UNPACKING

<sup>1</sup> Only for ADC-WRF35

<sup>2</sup> Only for ADC-WRF35 and ADC-RF35

**Compact disc changer**

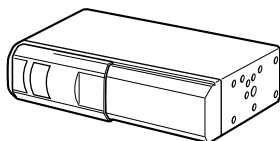

**Compact disc magazine**



**Connecting cable**

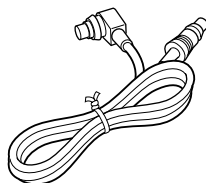

**Wired remote control <sup>2</sup>**

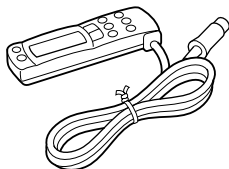

**Power unit & FM modulator <sup>2</sup>**

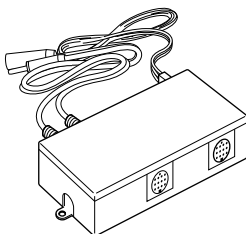

**Wireless remote control <sup>1</sup>**

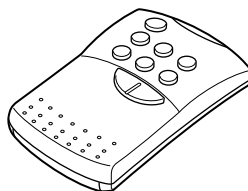

**Tapping screw <sup>2</sup>**  
for the power unit &  
FM modulator (2 ea.)



**Double-back tape (medium) <sup>2</sup>**  
for the wired remote control (1 set)

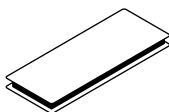

**Double-back tape (small) <sup>1</sup>**  
for the wireless remote control  
(1 set)



## Supplied mounting kit

for the compact disc changer

The letters are keyed to those in the instructions.

Use only the supplied mounting hardware for safe and secure installation.

**a** Brackets (2 ea.)

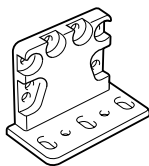

**b** Washer screws  
(4 ea.)



**c** Tapping screws  
(4 ea.)



**d** Plate brackets  
(2 ea.)

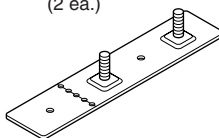

**e** Wing nuts (4 ea.)



**f** Double-back tape  
(large) (2 sets)

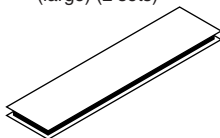

**g** Key (1 ea.)

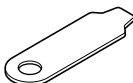

**h** Tapping screws  
(4 ea.)



**i** Adhesive label (1 set)

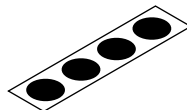

# INSTALLATIONS

## Precautions

Select the mounting location very carefully, referring to the following points.

- Make sure that there is no fuel tank, wiring or piping on the other side of the mounting surface.
- Make sure that the installation of the unit will not hinder the movement of the deck lid or interfere with the spare tire, etc.
- Use only the supplied mounting kit for safe and proper installation.

## Removing the transport screws

Find the four transport screws at the bottom of the unit, which lock the unit's mechanism during transport. Remove these screws before installation and attach the supplied adhesive labels over the holes.

Retain these screws and replace them in the original positions if the unit is transported for service or maintenance.

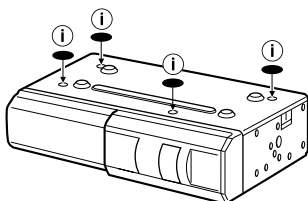
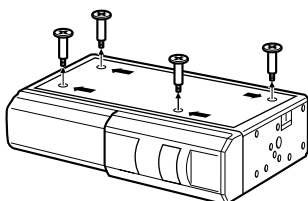

## Mounting angle setting dials

Be sure to change the position of the mounting angle setting dials according to the angle at which the unit is to be installed.

Mounting angle setting dial

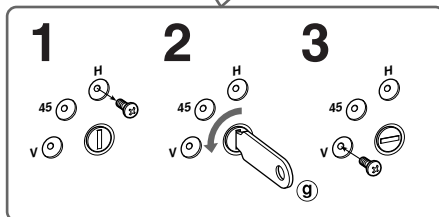
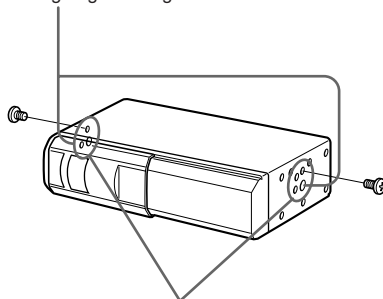

For example, in relevance to the diagram above, the following procedure would be used to change the position from H (horizontal) to V (vertical).

- 1 Remove the locking screw.
- 2 Using the supplied key, turn the dial to the position corresponding to the angle at which the unit is to be installed.  
H: Horizontal/suspended installation  
45: 45° (slanted) installation  
V: Vertical installation
- 3 Install the locking screw in the corresponding hole.
- 4 Follow the same procedure for the other side of the unit.

### Note

- The mounting angle setting dials on each side of the unit are factory-set to the H (horizontal) position.

## Horizontal installation

### 1

#### Construction

For details on (a)(b)(c)..., see page 4.

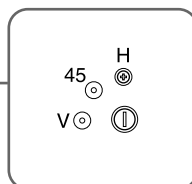
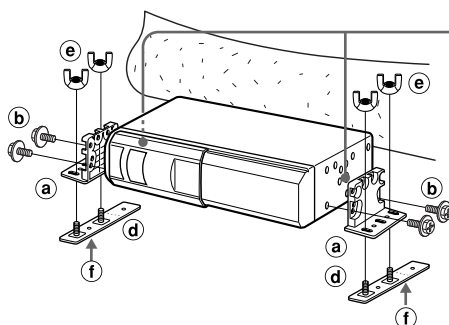

#### Note

If the mounting surface needs to be strengthened, secure the plate brackets (d) to the bottom surface of the car trunk, etc. with the tapping screws (h).

### 2

#### Deciding the position

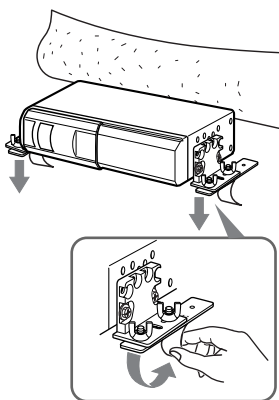

### 4

#### Making holes in the carpet

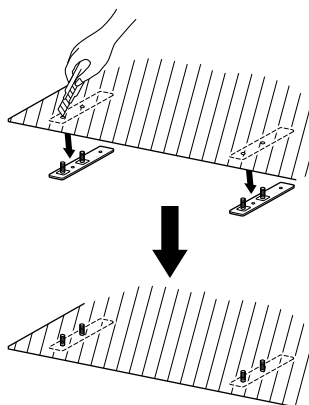

### 3

#### Removing temporarily

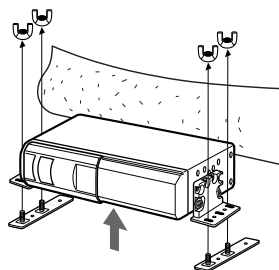

### 5

#### Completion

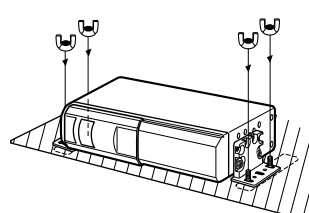

## Vertical installation

### 1 Construction

For details on (a)(b)(c) ..., see page 4.

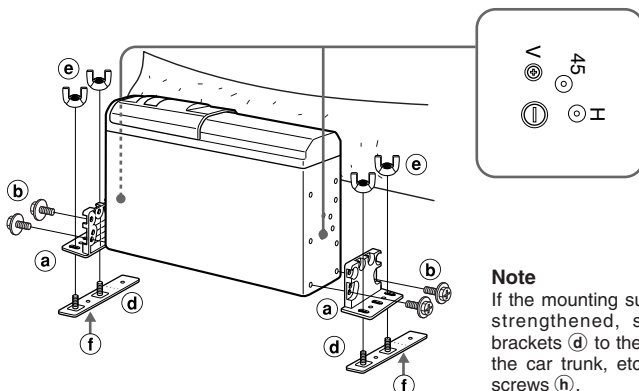

#### Note

If the mounting surface needs to be strengthened, secure the plate brackets (d) to the bottom surface of the car trunk, etc. with the tapping screws (h).

### 2 Deciding the position

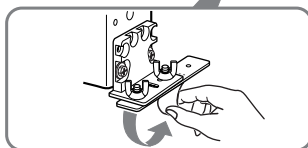
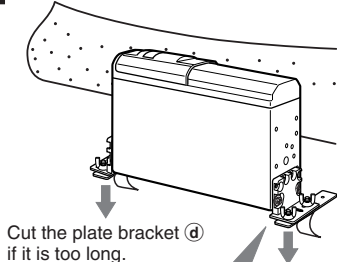

### 4 Making holes in the carpet

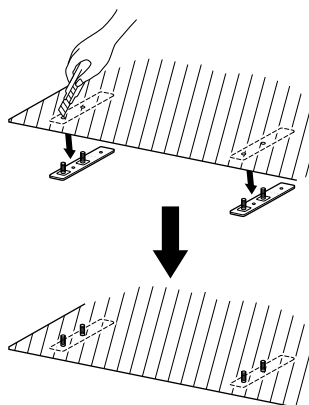

### 3 Removing temporarily

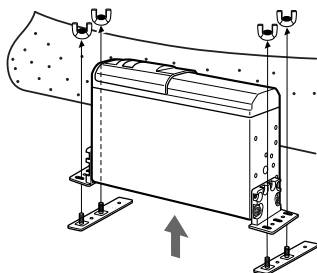

### 5 Completion

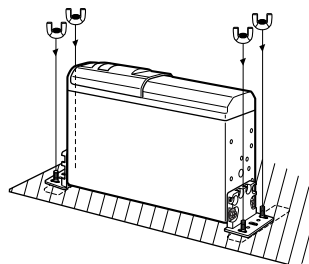

## Suspended installation

When installing the unit in the trunk below the package tray, observe the following.

- Make sure that the unit is suspended horizontally.
- Select the mounting location carefully so that the unit does not hinder the movement of the torsion bars of the deck lid.

## Caution

Before drilling the holes, make sure that there is nothing on the other side of the mounting surface.

## 1

### Construction

For details on (a) (b) (c) ..., see page 4.

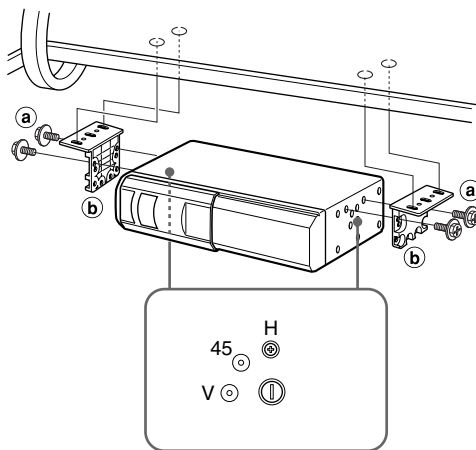

## 2

### Making holes

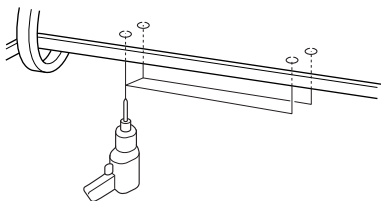

## 3

### Completion

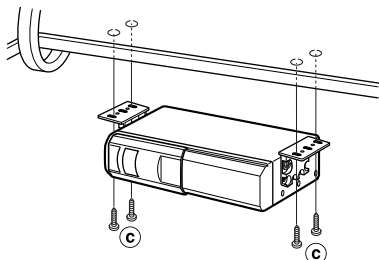

### Slanted installation

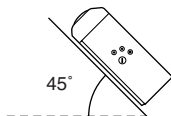

Be sure to turn the mounting angle setting dial to the 45 position.



# CONNECTIONS

## Layout and wiring example

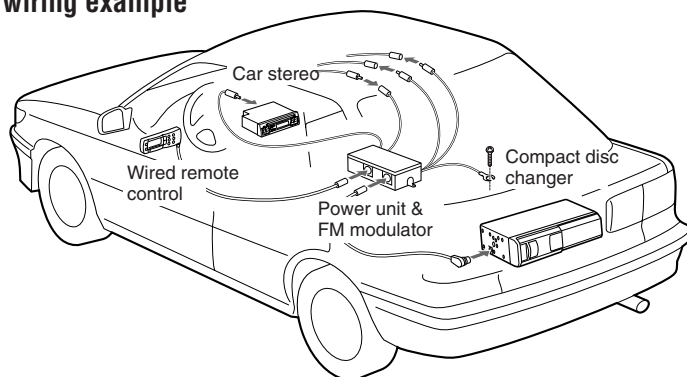

## Securing the wired and wireless remote control

### Wired remote control

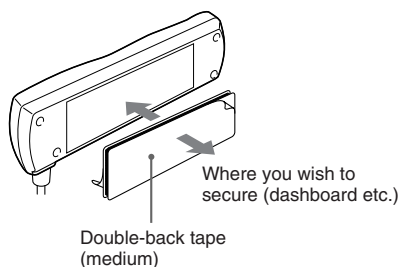

### Note

- Choose the mounting location carefully so that the unit will not interfere with normal driving functions.
- Be sure that the securing surface where the control will be located is clean and dry.

### Wireless remote control

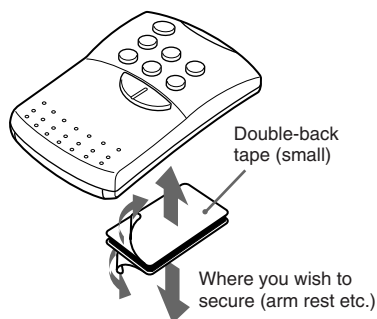

## Securing the power unit & FM modulator

### Power unit & FM modulator

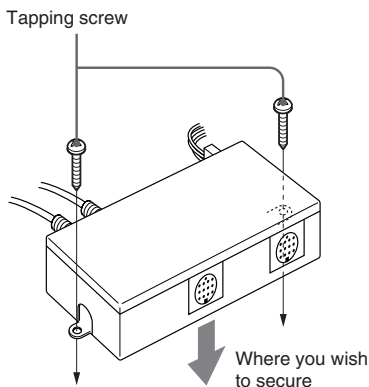

## Connection diagram

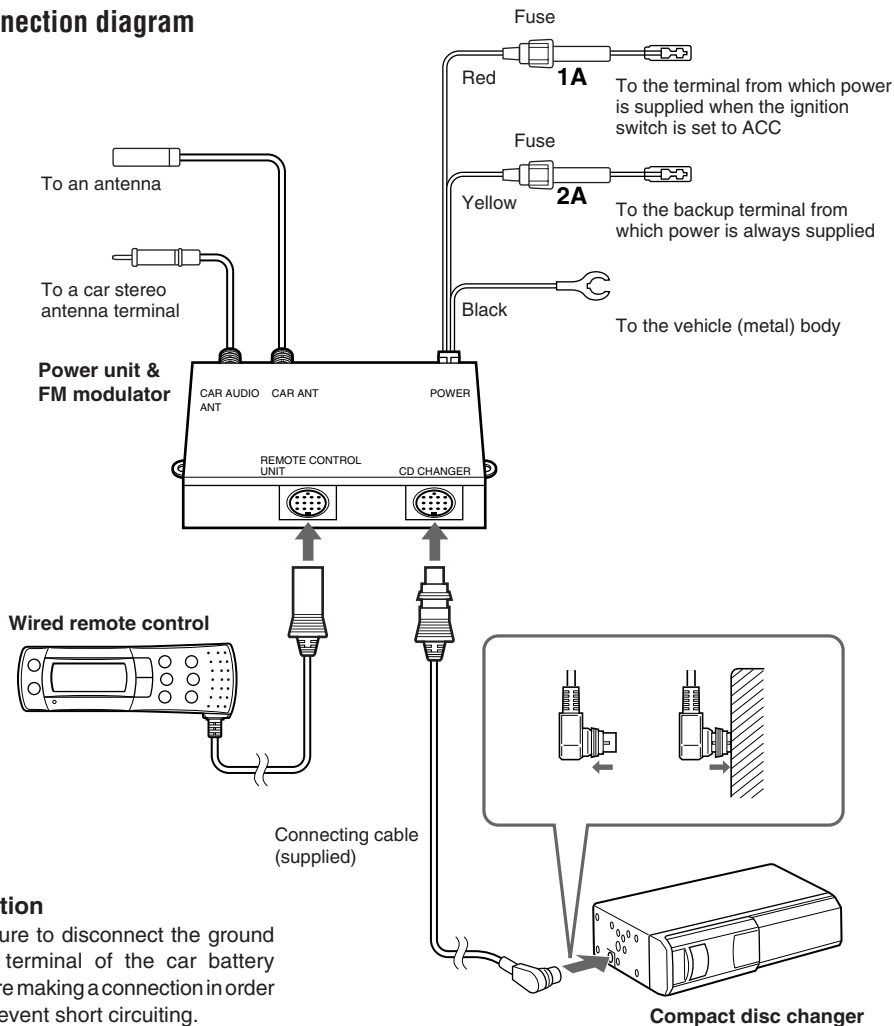

### Caution

Be sure to disconnect the ground wire terminal of the car battery before making a connection in order to prevent short circuiting.

### Notes

- Use only the supplied connecting cable. Using an unspecified connecting cable may cause background noise.
- After all the connections have been completed, be sure to press either of the reset buttons on the compact disc changer or wired remote control (see page 3).
- Be sure to select the output frequency and adjust the output level with the FREQUENCY SELECT switch and LEVEL control before securing the power unit & FM modulator (see page 11).
- The terminals on the power unit & FM modulator for connecting the wired remote control and the supplied connecting cable look similar. Be careful not to use the wrong terminal.

## Adjustments on the power unit & FM modulator

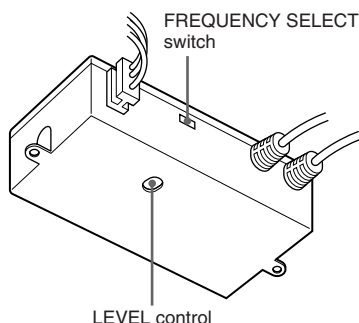

### Switching the frequency

When sound distortion due to noise occurs, change the current position of the FREQUENCY SELECT switch to the other position (88.7 or 89.1 MHz) using a screwdriver or similar tool, which may eliminate the noise. The selection of the appropriate frequency must be done before securing the power unit & FM modulator in position.

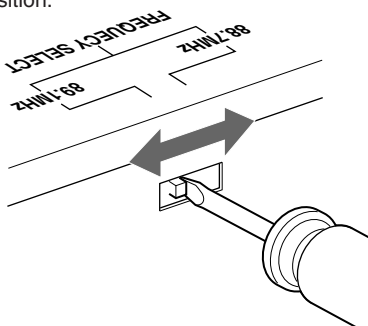

### Note

The radio sensitivity may be slightly reduced when the power unit & FM modulator is connected. In this case, turn off the compact disc changer.

### Adjusting the output level

The LEVEL control on the power unit & FM modulator is set to the center position, an average level commonly used, at the factory. If necessary, adjust the level according to following these steps before securing the power unit & FM modulator in position.

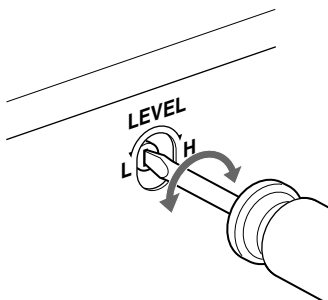

- 1 On your car stereo, select one of FM programs available and adjust a sound volume to the level of your preference. This volume will be used as a reference to adjust CD sound volume in step 4.
- 2 Select a frequency 88.7 or 89.1 MHz according to the selection on the FREQUENCY SELECT switch of the power unit & FM modulator.
- 3 Play a CD placed in the compact disc changer.
- 4 Adjust the sound volume with the CD playing so as to match the volume adjusted in step 1.

### Note

Setting this control to maximum or to an excessively high level will cause sound distortion.

# HOW TO USE

## How to use a compact disc magazine

1

With the label side up, insert a CD all the way.

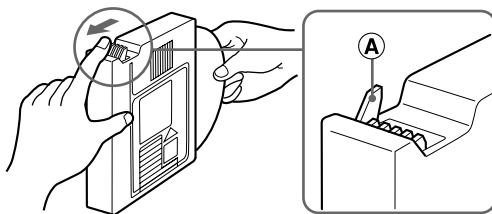
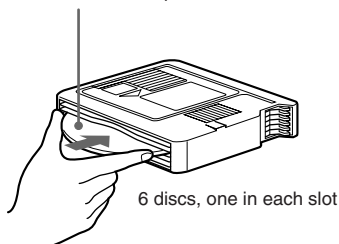

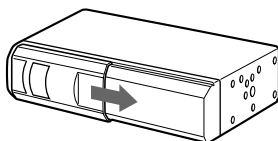

To remove a CD, pull part ① in the direction of the arrow as illustrated.

2

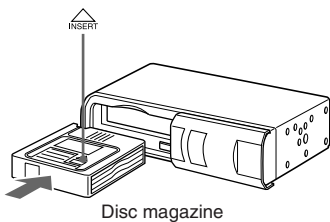

3



Insert the magazine (which has been taken out of the unit) firmly with the  mark visible on the top side.

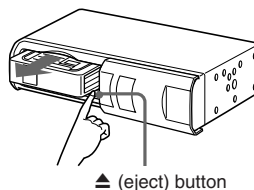

To remove the magazine, press the  button and pull out the disc magazine.

4

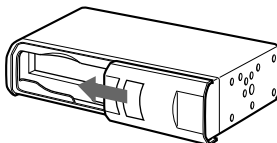

## CD play

- 1** Turn on your car stereo (not supplied) and select the FM band.
- 2** Select an appropriate frequency (88.7 or 89.1 MHz).  
(See page 11 for details.)
- 3** Press **PWR** on the wired remote control or **POWER** on the wireless remote control.  
CD play starts.

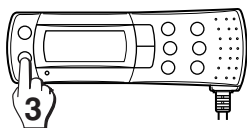

- 4** Adjust the sound volume on your car stereo (not supplied).

## Remote control

### Inserting the batteries

insert the supplied R03 (size AAA) batteries.  
Be sure to match  $\oplus$  and  $\ominus$  on the batteries to the diagram inside the battery holder.

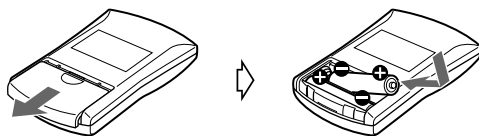

### Note

- Do NOT mix new batteries with old ones.
- Do NOT mix different brands of batteries.
- Remove the batteries when they have discharged, or when you will not use the wireless remote control for a long period of time.

### Using the wireless remote control

Point the wireless remote control toward remote sensor.

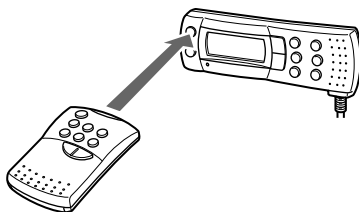

### Note

- The wireless remote control may not operate when there is any obstruction between the remote control and remote sensor.
- Strong ambient light sources such as a fluorescent lamp or direct sunlight may cause unreliable operation.

## Wired and wireless remote control

### Wired remote control

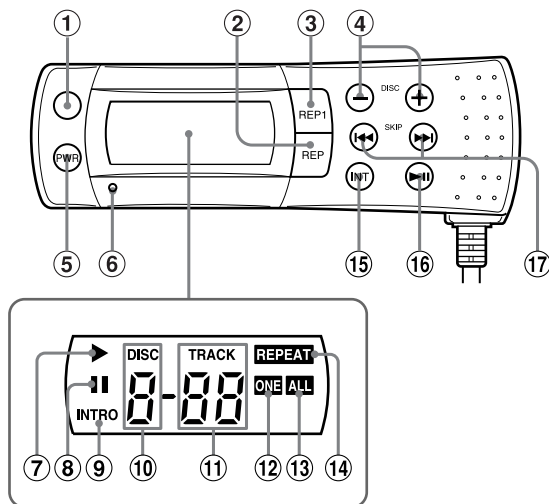

- ① **Remote sensor**
- ② **REP (repeat) button**  
Press to repeat the currently played track.  
Press again to cancel.
- ③ **REP 1 (repeat 1) button**  
Press to repeat the currently played disc.  
Press again to cancel.
- ④ **– DISC + buttons**  
Press DISC – to play the previous disc, or  
DISC + to play the next disc.
- ⑤ **PWR/POWER button**  
Press to turn on the compact disc changer.  
Press again to turn off the changer.
- ⑥ **Reset button**  
Press to reset the compact disc changer if a  
malfunction occurs.
- ⑦ **▶ (play) indicator**
- ⑧ **|| (pause) indicator**

### Wireless remote control

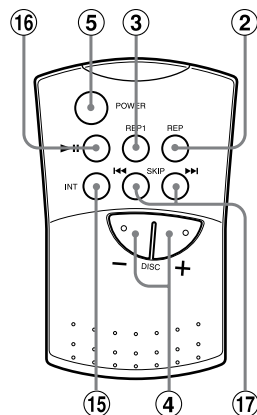

- ⑨ **INTRO indicator**
- ⑩ **DISC number indicator**
- ⑪ **TRACK indicator**
- ⑫ **ONE indicator**  
Appears when the changer repeats the  
currently played track.
- ⑬ **ALL indicator**  
Appears when the changer repeats the  
currently played disc.
- ⑭ **REPEAT indicator**
- ⑮ **INT (intro) button**  
Press to play the first 10 seconds of the  
tracks on all the discs.
- ⑯ **▶ || (play/pause) button**  
Press to play a disc. Press to pause during  
CD play.
- ⑰ **◀◀ SKIP ▶▶ buttons**  
Press to skip a track backward/forward.  
Press and hold down for high speed audible  
search backward/forward.

## Error codes

In the following cases the corresponding error code indication will be displayed. Follow the suggestions below to solve the problem. If the error code indication does not disappear, consult an AIWA service center.

- ERROR01** The disc magazine is not properly inserted in the compact disc changer. Re-insert the magazine.
- ERROR02** No discs are loaded into the disc magazine. Insert discs properly.
- ERROR03** Focus error. Check that the discs are loaded properly into the disc magazine (right side up, etc.)
- ERROR04** Problem with the compact disc changer. Reset the unit by pressing the reset button. If this does not correct the problem, consult an AIWA service center.
- ERROR05** The compact disc changer is overheated. Allow the changer to cool off by moving the vehicle out of direct sunlight.

## Reset button

Press the button either on the wired remote control or the compact disc changer by inserting the tip of a pointed object such as a ball-point pen or toothpick into the opening to reset the unit when the compact disc changer does not operate properly. Press to reset the unit after a malfunction. Note that the memory contents will be erased upon your pressing the reset button. (see page 3)

## Compact disc changer (ADC-M35)

System	Compact disc digital audio system
Frequency response	5 Hz–20 kHz
Wow and flutter	Below measurable limit
Signal to noise ratio	97 dB
Outputs	Line output (for changer connector only)
Operating temperature	–10 °C to 55 °C
Dimensions	289 x 77 x 200.5 mm (w/h/d) (11 1/2 x 3 1/8 x 8 in.)
Weight	2.8 kg (6.16 lbs.)
Power requirement	12 V DC car battery (negative ground)
D/A converter	1 bit DAC, 8 times over sampling
Sampling rate	44.1 kHz
Disc size	120 mm
Supplied accessories	Disc magazine (1) Mounting kit (1 set) Connecting cable (5 m) (16.4 ft.) (1)

## Power unit & FM modulator

Transfer frequency	88.7/89.1 MHz switchable
Dimensions	126 x 65 x 31 mm (w/h/d) (5 x 2 5/8 x 1 1/4 in.)
Weight	300 g (10.5 lb.)

## Wired remote control

Dimensions	134 x 48 x 21 mm (w/h/d) (5 3/8 x 1 15/16 x 27/32 in.)
Cord length	1.4 m (4.59 ft.)
Weight	180 g (6.3 lb.)

## Wireless remote control

Dimensions	64 x 100 x 20 mm (w/h/d) (2 5/8 x 4 x 13/16 in.)
Weight	60 g (2.1 lb.)

Design and specifications are subject to change without notice.

