

Choosing Power Sources

Rear Panel

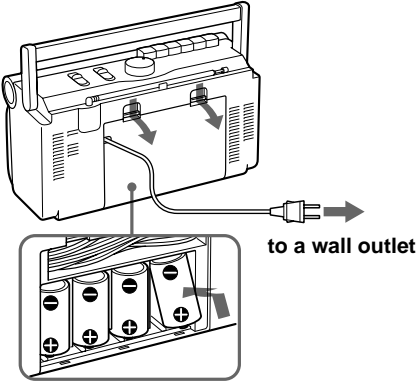

Note

Replace the batteries when the player stops operating. Replace all the batteries with new ones.

Specifications

- Frequency range**
CFM-20: FM: 87.6 - 108 MHz
AM: 530 - 1 710 kHz
CFM-30TW: TV H (WEATHER): 7 - 13 ch
TV L/FM: 2 - 6 ch/ 87.6 - 108 MHz
AM: 530 - 1 710 kHz
- Antennas** FM/TV: Telescope antenna
AM: Built-in ferrite bar
- Recording system** 2-track, mono
- Frequency response** 100 - 6 300 Hz
- Speakers** Full-range: 7.7 cm (3 1/8 inches) dia × 1
- Power output** 0.8 W (at 10 % harmonic distortion in DC operation)
- Battery life**

FM recording
Sony R20P: Approx. 18 hours
Sony LR20 alkaline: Approx. 50 hours
Playback
Sony R20P: Approx. 16 hours
Sony LR20 alkaline: Approx. 42 hours

Connecting the AC power cord

Open the battery compartment and take out the AC power cord. An opening in the compartment door permits AC operation with the door in its place. Then, connect the AC power cord to the wall outlet.

Using the player on batteries

Insert four size D (R20) batteries (not supplied) into the battery compartment.

Troubleshooting

There is no audio.

- Connect the AC power cord securely.
- Insert the batteries properly.
- Replace all the batteries if they are weak.
- Adjust the volume.
- Set FUNCTION to the position you want to operate.

Noise is heard.

- Someone is using a portable telephone or other equipment that emits radio waves near the player. Move the portable telephone, etc., away from the player.

Cassette cannot be inserted.

- Insert the cassette properly.
- Press to release .

The button does not function.

- No cassette is in the tape compartment.
- Make sure the safety tab on the cassette is in place.

Poor playback, recording or erasing quality.

- Dirty heads. Clean the illustrated portions with a cleaning swab slightly moistened with cleaning fluid or alcohol.
- Demagnetize the heads and all metal parts in the tape path with a commercially available tape head demagnetizer.

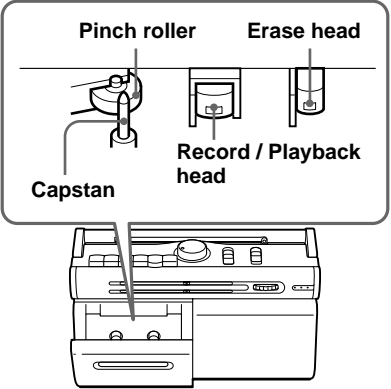

Precautions

On safety/power sources

- Should any solid object or liquid fall into the player, unplug the player, and have it checked by qualified personnel before operating it any further.
- Unplug the player from the wall outlet when it is not to be used for an extended period of time.
- For battery operation, use four size D (R20) batteries.
- When the batteries are not to be used, remove them to avoid damage that can be caused by battery leakage or corrosion.
- The nameplate indicating operating voltage, power consumption, etc. is located at the bottom.

On placement/operation

- Do not leave the player in a location near heat sources, or in a place subject to direct sunlight, excessive dust or mechanical shock.
- Do not place anything within 10 mm of the rear side of the unit. The ventilation holes must be unobstructed for the player to operate properly and to prolong the life of its components.
- Since a strong magnet is used for the speakers, keep personal credit cards using magnetic coding or spring-wound watches away from the player to prevent possible damage from the magnet.
- Do not lift the handle when the telescopic antenna is extended.
- If the player has not been used for a long time, set it in the playback mode to warm it up for a few minutes before inserting a cassette.

Notes on cassettes

- Break off the cassette tab from side A or B to prevent accidental recording. If you want to reuse the tape for recording, cover the broken tab with adhesive tape.
- The use of a cassette with more than 90 minutes of play time is not recommended except for long, continuous recording or playback.

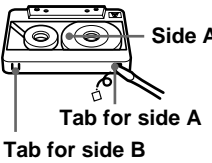

If you have questions or problems concerning your player, please consult your nearest Sony dealer.

SONY

3-228-217-11 (1)

Radio Cassette-Corder

Operating Instructions

Owner's Record

The model number is located at the bottom, and the serial number is located in the battery compartment. Record these numbers in the spaces provided below. Refer to them whenever you call upon your Sony dealer regarding this product.

Model No. _____ Serial No. _____

CFM-20/30TW

Sony Corporation ©2001 Printed in China

<http://www.world.sony.com/>

WARNING

To prevent fire or shock hazard, do not expose the player to rain or moisture.

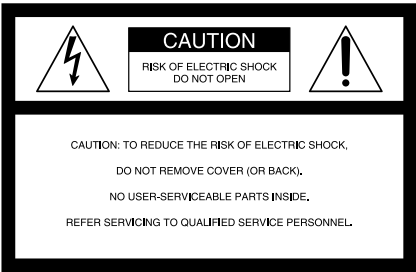

This symbol is intended to alert the user to the presence of uninsulated "dangerous voltage" within the product's enclosure that may be of sufficient magnitude to constitute a risk of electric shock to persons.



This symbol is intended to alert the user to the presence of important operating and maintenance (servicing) instructions in the literature accompanying the appliance.

You are cautioned that any changes or modifications not expressly approved in this manual could void your authority to operate this equipment.

If you have any questions about this product, you may call: Sony Direct Response Center 1-(800)-222-7669 or write to: Sony Direct Response Center 12451 Gateway Blvd. Fort Myers, FL 33913

Declaration of Conformity

Trade Name: SONY
Model No.: CFM-30TW
Responsible Party: Sony Electronics Inc.
Address: 1 Sony Drive, Park Ridge, NJ. 07656 USA
Telephone No.: 201-930-6972

This device complies with Part 15 of the FCC Rules. Operation is subject to the following two conditions: (1) This device may not cause harmful interference, and (2) this device must accept any interference received, including interference that may cause undesired operation.

WARNING

Do not install the appliance in a confined space, such as a bookcase or built-in cabinet.

For customers in Canada

To prevent electric shock, match wide blade of plug to wide slot, fully insert.

Location and controls

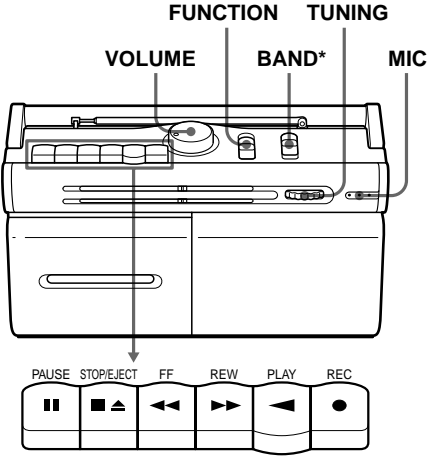

* CFM-30TW only

To turn off the radio
Set FUNCTION to TAPE/RADIO OFF.

To improve broadcast reception
Reorient the antenna for FM/TV. Reorient the player itself for AM.

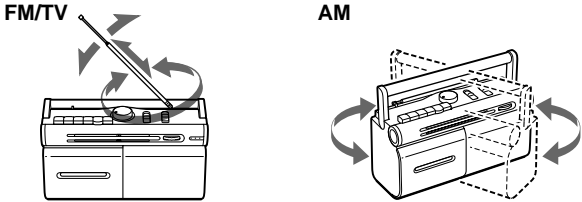

Tip
For the best results, move the player away from the TV receiver.

Listening to the radio

1 CFM-20: Set FUNCTION to the band you want.
CFM-30TW: Set FUNCTION to RADIO.

CFM-20 CFM-30TW

2 CFM-20: Skip this step.
CFM-30TW: Select the desired band.
To listen to the WEATHER band, set BAND to TV H.

BAND

3 Tune in the station you want.

Playing a tape

Use TYPE I (normal) tape only.

1 Set FUNCTION to TAPE/RADIO OFF.

CFM-20 CFM-30TW

2 Insert a recorded tape.

With the side you want to play facing forward.

3 Press ◀.

To	Press
stop playback	■▲ When the tape ends, the playback stops.
fast-forward or rewind the tape	◀◀ or ▶▶
pause playback	 Press the button again to resume playback.
eject the cassette	■▲

Recording

Use TYPE I (normal) tape only.

1 To record from the radio
Tune in the station you want.

To record from the built-in microphone (MIC)
Set FUNCTION to TAPE/RADIO OFF.

2 Insert a blank tape.

With the side you want to record on facing forward.

3 Press ●.
(◀ is depressed automatically.)

Tips

- For the best results, use the AC power source.
- Adjusting the volume will not affect the recording level.