

NOR: Type I (Normal) tape  
HI/MTL: Type II (high/CrO<sub>2</sub>) or Type IV (metal) tape

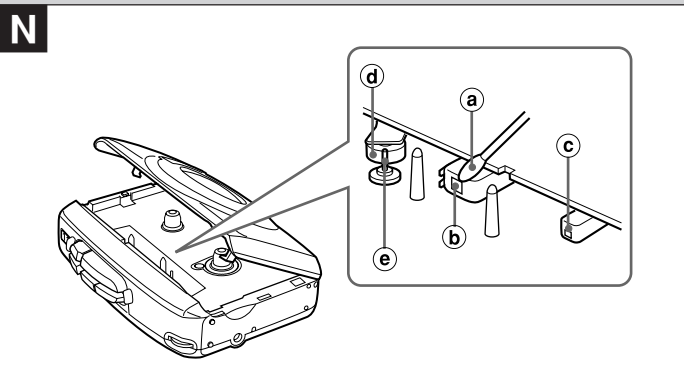
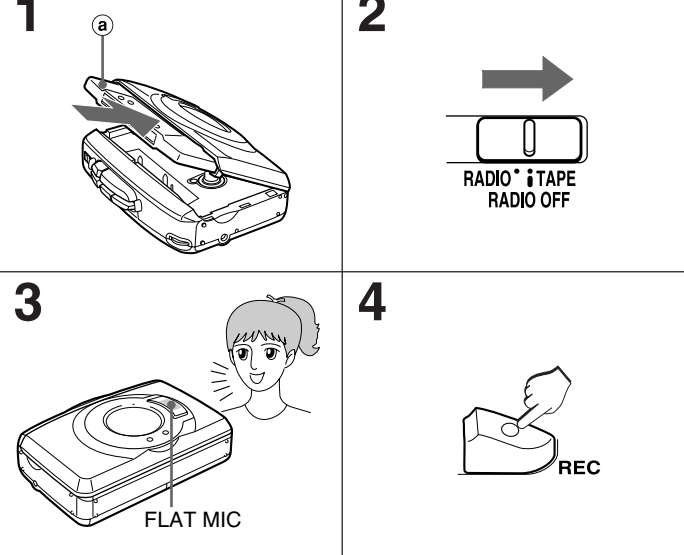
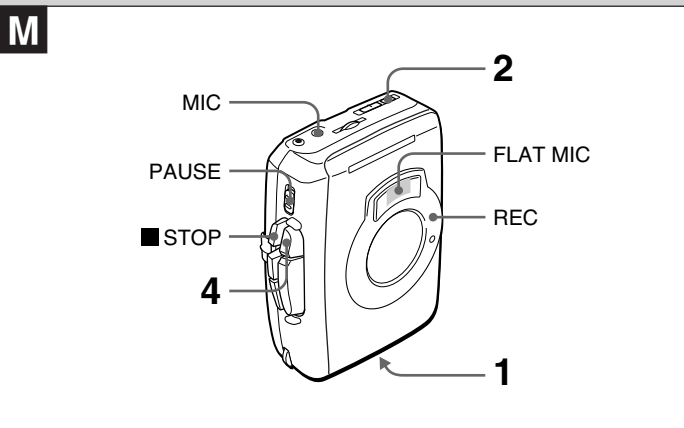
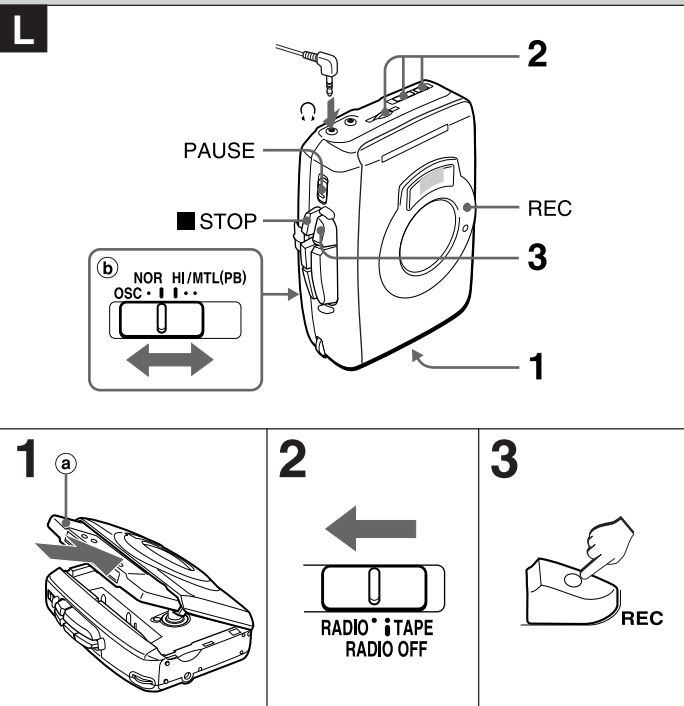
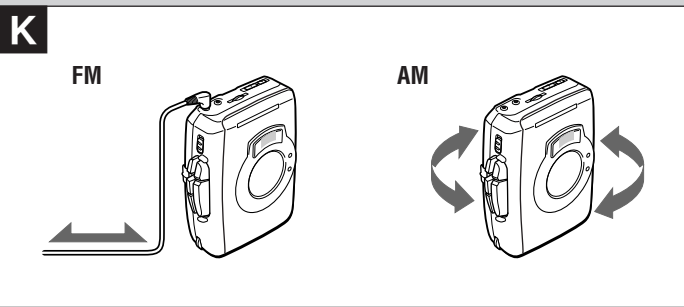
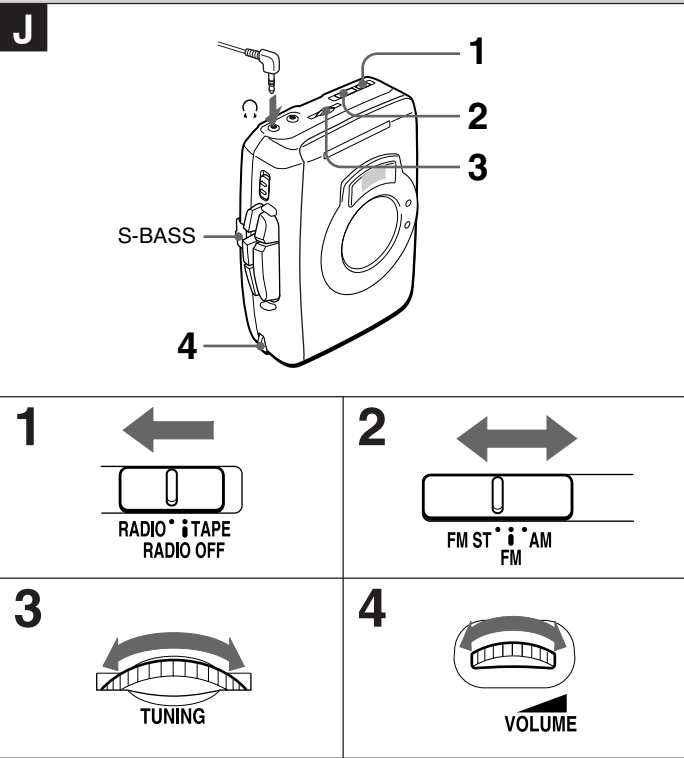

## RADIO RECEPTION **J**

- 1 Set the RADIO/TAPE switch to RADIO.
  - 2 Select AM or FM ST (stereo).
  - 3 Turn the TUNING control to tune in to a station.
  - 4 Adjust the volume.
- After listening, set the RADIO/TAPE switch to TAPE to turn off the power.

**Super bass**  
Set the S-BASS switch to ON to emphasize the low frequencies.

**If the FM stereo signal is weak**  
Select FM in step 2.  
The sound will be heard in monaural, but distortion will be reduced.

**For better reception **K****  
FM: The headphone cord functions as the FM antenna. Keep it extended.  
AM: Turn the unit to find the position which gives the best reception.

## RECORDING FROM THE RADIO **L**

- Use Type I (normal) tape for recording.
- Recording is done on the side facing the cassette holder.

- 1 Insert a cassette.
    - Ⓐ The side to be recorded on
  - 2 Tune in to a station.
  - 3 Press ● REC to start recording.
    - The ◀PLAY button is depressed simultaneously, and the REC indicator flashes in red.
- After recording, set the RADIO/TAPE switch to TAPE to turn off the power.

Basic operation	
To stop	Press ■ STOP.
To pause	Set the PAUSE switch to ON. The REC indicator lights in green. To resume, set it to OFF.

- When the end of the tape is reached, recording stops and ● REC and ◀PLAY are released.
- The PAUSE switch is released automatically when the ■ STOP button is pressed.

**If a high-pitched sound is heard during recording from AM**  
Set the OSC switch Ⓑ to the position that less noise is heard.

## RECORDING FROM THE MICROPHONE **M**

- Use Type I (normal) tape for recording.
- Recording is done on the side facing the cassette holder.
- You can record from the FLAT MIC (built-in microphone) or optional external microphone.

### Recording with the FLAT MIC

The recorded sound will be monaural.

- 1 Insert a cassette.
  - Ⓐ The side to be recorded on
- 2 Set the RADIO/TAPE switch to TAPE.
- 3 Place the unit on a desk, etc. with the FLAT MIC facing upward and oriented to the sound source.
- 4 Press ● REC to start recording.
  - The ◀PLAY button is depressed simultaneously, and the REC indicator flashes in red.

Basic operation	
To stop	Press ■ STOP.
To pause	Set the PAUSE switch to ON. The REC indicator lights in green. To resume, set it to OFF.

- When the end of the tape is reached, recording stops and ● REC and ◀PLAY are released.
- The PAUSE switch is released automatically when the ■ STOP button is pressed.

**Note**  
When you record with the FLAT MIC, make sure that no other microphone is connected to the MIC jack.

**To start recording immediately during playback**  
Press ● REC during playback. Recording starts immediately.

**If a high-pitched howling sound is heard**  
Move the headphones and the microphone farther apart, or reduce the volume. Adjusting the output volume does not affect the sound to be recorded.

### Recording with the optional external microphone

Connect an optional external microphone to the MIC jack before recording. In this case, the recorded sound will be stereo. Connecting a microphone to the MIC jack deactivates the FLAT MIC.

## MAINTENANCE **N**

**To clean the head and the tape path**  
After every 10 hours of use, clean the head and the tape path with a head cleaning cassette or cotton swab moistened with cleaning fluid or denatured alcohol. (These cleaning kits are commercially available.)  
When cleaning with a cotton swab Ⓐ, wipe Ⓑ, Ⓒ, Ⓓ and Ⓔ.

**To clean the cabinet**  
Use a soft cloth lightly moistened with a mild detergent solution.  
Do not use strong solvents such as alcohol, benzene or thinner.

## SPECIFICATIONS

**Frequency range:** FM 87.5 – 108 MHz; AM 530 – 1,605 kHz  
**Maximum output:** 6 mW + 6 mW (JEITA 32 ohms)  
**Power sources:** DC 3 V using two R6 (size AA) dry cell batteries, AC house current using the optional AC power adaptor Sony AC-E30HG.

**Maximum dimensions:**  
120.7 (W) × 91 (H) × 39.4 (D) mm  
(4 7/8 × 3 5/8 × 1 9/16 in.)  
**Weight:** Approx. 166 g (5.8 oz) excluding the batteries  
**Accessories:** Stereo headphones (1)  
Belt clip (1)

- The specifications and external appearance of this unit are subject to change without notice.

### COPYRIGHT

Please check the laws on copyright relating to recording from discs, radio or external tape for the country in which the unit is being used.