

FM/AM Radio

Operating Instructions

ICF-B01

© 2006 Sony Corporation Printed in China

http://www.sony.net/

For customers who purchased this product in the USA
Please register this product on line at
<http://www.sony.com/productregistration> .
Proper registration will enable us to send you periodic mailings about new products, services, and other important announcements.
Registering your product will also allow us to contact you in the unlikely event that the product needs adjustment or modification. Thank you.

You are cautioned that any changes or modifications not expressly approved in this manual could void your authority to operate this equipment.

Features

- Self-Powered emergency radio for disaster preparedness
- You can use the radio anytime by turning the Power Generator handle to charge the built-in rechargeable battery.
 - Self power-generating function
- Uses size AAA (R03) dry batteries (not supplied)
- Two types of useful LED lights (Flashlight/Soft light) equipped
- Water resistant for all weather operation

*** Do not immerse in water**
This product is designed to be splash-resistant, but should not be immersed in water or come in continuous contact with water.
Before installing the batteries, be sure to wipe off drops of water on the unit.

Precautions

- Do not drop the unit or give a shock to the unit, or it may cause a malfunction.
- Do not leave the unit in a location near heat sources, or in a place subject to direct sunlight, excessive dust, or mechanical shock.
- Should any solid object or liquid fall into the unit, remove the batteries, and have the unit checked by qualified personnel before operating it any further.
- Do not open the cabinet other than when disposing the unit.
- When the case becomes soiled, clean it with a soft cloth dampened with a mild detergent solution. Never use abrasive cleansers or chemical solvents, as they may mar the case.
- Do not leave magnetic bank cards, magnetic train passes, or other cards containing magnetic information near the speaker. The information on the card may be erased by the magnetism inside the speaker.
- Keep the volume at a moderate level so as not to harm your ears.
- When using a separately sold earphone, keep the earphone clean by wiping the plug of the earphone with a soft dry cloth so you can always hear clear radio sound.

On water resistant

Although this unit is water resistant for all weather operation, take special care of the following situations.

- Do not splash large amount of water on the unit.
- Do not immerse the unit in water.
- Cover the jack with the attached rubber cap when the earphone is not used.
- If the unit is splashed with salt water, wipe clean with a damp cloth, then dry with a soft cloth. Do not wash under running water, do not use soap or detergent and do not dry with an electric hair dryer.
- If water has got into the speaker, turn the face of the unit down and pour the water out from the speaker.
- Before opening the battery compartment, be sure the outside of the unit is clean and dry.

RECYCLING NICKEL METAL HYDRIDE BATTERIES

Nickel Metal Hydride batteries are recyclable.
You can help preserve our environment by returning your used rechargeable batteries to the collection and recycling location nearest you.



For more information regarding recycling of rechargeable batteries, call toll free 1-800-822-8837, or visit <http://www.rbrc.org/>

Caution: Do not handle damaged or leaking Nickel Metal Hydride batteries.

When disposing the unit Take out the rechargeable battery for recycle.

- Do not open the cabinet other than when disposing the unit.
- 1 Detach the LED light (SOFT LIGHT) cover.
Remove the 2 screws at the antenna rest on the rear of the unit.
 - 2 Remove the left and right side cabinets.
When removing the right cabinet, gently pry up and remove the 3 dials, then remove the screw at the **VOL** control.
When removing the left cabinet, remove the screw near the  (earphone) jack.
 - 3 Remove the rear cabinet.
Remove the 4 screws at the rear of the unit and 2 screws in the battery compartment.
You do not have to remove the screw which fixes the telescopic antenna.
 - 4 Remove the screw on the board.
Remove the rechargeable battery after detaching the board.

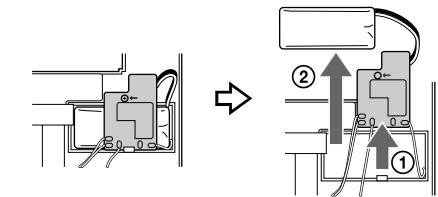

- 5 Holding the connector plug, disconnect the rechargeable battery from the board.

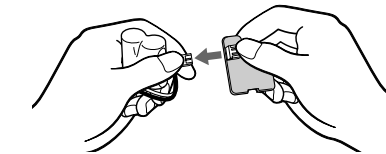

Notes

- Be sure to disconnect the rechargeable battery from the board. If it is connected, electric leakage may occur and it is dangerous. When taking out the battery, be careful not to touch the interior of other parts.
- Be sure to confirm that the rechargeable battery is completely exhausted and then take out the rechargeable battery.

If you have any questions or problem concerning your unit, please consult the nearest Sony dealer.

SONY®

Tape Cassette Player/Recorder/CD Player/Mini Disc
DAT/Radio/Head Phone/Speaker/MIC/Personals

Portable Audio

LIMITED WARRANTY

Sony Electronics Inc. (“Sony”) warrants this Product (including any accessories) against defects in material or workmanship as follows:

1. For a period of one (1) year from the date of purchase if this Product is determined to be defective, Sony will repair or replace the Product, at its option, at no charge. After this one (1) year period, you must pay for the replacement unit. This warranty does not cover costs incurred in connection with the removal and re-installation of radios, speakers or accessories, nor does it cover any other contingent expenses.
2. To obtain warranty service, you must take the Product, or deliver the Product freight prepaid, in either its original packaging or packaging affording an equal degree of protection, to any Factory Sony Service facility or to the Laredo Fulfillment Center. See below for additional information.

This warranty does not cover customer instruction, installation, set up adjustments or signal reception problems.

This warranty does not cover cosmetic damage or damage due to acts of God, accident, misuse, abuse, negligence, commercial use, or modification of, or to any part of the Product, including the antenna. This warranty does not cover damage due to improper operation or maintenance, connection to improper voltage supply, or attempted repair by anyone other than a facility authorized by Sony to service the Product. This warranty does not cover Products sold AS IS or WITH ALL FAULTS, or consumables (such as fuses or batteries). This warranty is valid only in the United States.

Proof of purchase in the form of a bill of sale or receipted invoice which is evidence that the unit is within the Warranty period must be presented to obtain warranty service.

This warranty is invalid if the factory applied serial number has been altered or removed from the Product.

REPAIR OR REPLACEMENT AS PROVIDED UNDER THIS WARRANTY IS THE EXCLUSIVE REMEDY OF THE CONSUMER. SONY SHALL NOT BE LIABLE FOR ANY INCIDENTAL OR CONSEQUENTIAL DAMAGES FOR BREACH OF ANY EXPRESS OR IMPLIED WARRANTY ON THIS PRODUCT. EXCEPT TO THE EXTENT PROHIBITED BY APPLICABLE LAW, ANY IMPLIED WARRANTY OF MERCHANTABILITY OR FITNESS FOR A PARTICULAR PURPOSE ON THIS PRODUCT IS LIMITED IN DURATION TO THE DURATION OF THIS WARRANTY.

Some states do not allow the exclusion or limitation of incidental or consequential damages, or allow limitations on how long an implied warranty lasts, so the above limitations or exclusions may not apply to you. In addition, if you enter into a service contract with the Sony Partnership within 90 days of the date of sale, the limitation on how long an implied warranty lasts does not apply to you. This warranty gives you specific legal rights, and you may have other rights which vary from state to state.

The Address of the Laredo Fulfillment Center is:

Laredo Fulfillment Center
10227 Crossroads Loop Suite B
Laredo, TX 78045

For your convenience, Sony Electronics Inc. has established telephone numbers for frequently asked questions:

To locate the servicer or dealer nearest you, or for service assistance or resolution of a service problem, or for product information or operation, call:

Sony Customer Information Services Center
1-800-222-7669
or visit the Sony Web Site:
www.sony.com

For an accessory or part not available from your authorized dealer, call:

1-800-488-SONY (7669)

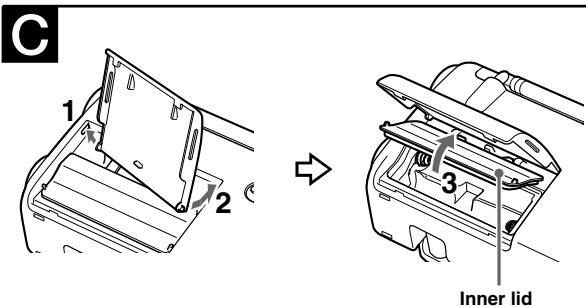
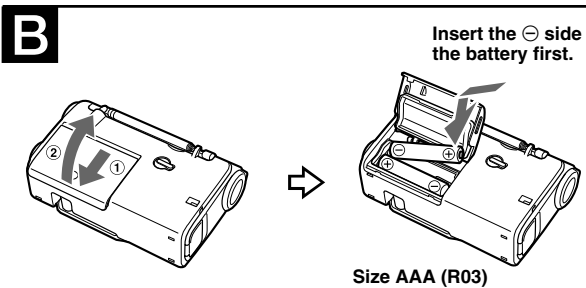
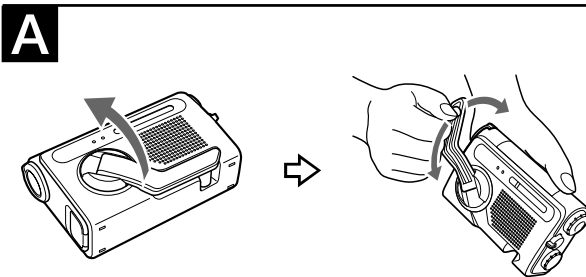
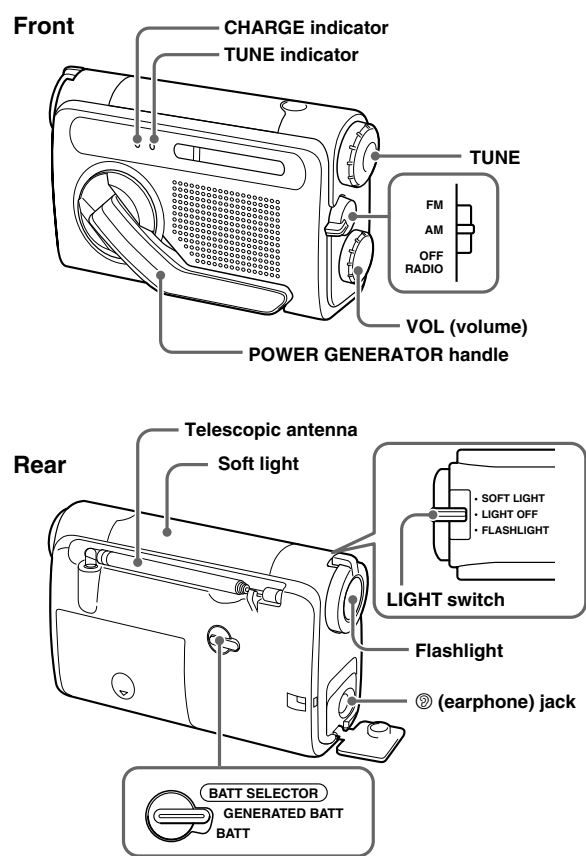

Power Sources

Using the unit with the built-in rechargeable battery (see fig. A)

You may charge the built-in rechargeable battery and listen to the radio.

- 1 Pull out the **POWER GENERATOR** handle.
- 2 To charge, turn the handle one way to either direction. Turn the handle slowly in the beginning, and speed up the turning little by little. Then, keep turning the handle continuously at the speed that lights the **CHARGE** indicator in green. When you charge, the built-in rechargeable battery will be charged regardless of the setting of the **BATT SELECTOR** switch.

Notes

- Be sure to fold in the telescopic antenna when charging. If you leave the telescopic antenna unfolded, the telescopic antenna may hit the surroundings and it is dangerous.
- If you turn the **POWER GENERATOR** handle while listening to the radio, there may be a noise interference. In this case, turn off the radio and then charge the battery.

On charging

When you turn the handle, the power generation starts and charges the built-in rechargeable battery. The generation capacity may vary depending on the speed. At first, turn the handle slowly and then speed up the turning little by little and the **CHARGE** indicator will light up. Keep on turning the handle for 1 minute at the speed that lights the **CHARGE** indicator in green, which will be up to 60 minutes* of listening to the radio. Use this as an charging standard. Even when you turn the handle at the speed that the **CHARGE** indicator does not light, it will charge the built-in rechargeable battery and you may listen to the radio. **The CHARGE indicator is not an indicator for charging capacity.**

* For AM radio reception and 40 minutes for FM radio reception. The listening time may differ depending on the operation of the unit.

When the rechargeable battery becomes exhausted

The sound will become weak and distorted. If this occurs, turn the **POWER GENERATOR** handle to charge the rechargeable battery.

Notes

- When you use the rechargeable battery for the first time, after a long period of time of disuse, leaving the power on for a long time or the rechargeable battery is exhausted, the battery life may be short even after charging it. In this case, charge (for more than a minute) and discharge the battery several times. The battery life will be restored.
- If the rechargeable battery capacity becomes half the normal life, please consult the nearest Sony dealer.

Installing the dry batteries (see fig. B)

Insert two size AAA (R03) batteries (not supplied).

- 1 Open the lid as illustrated.
- 2 Insert two size AAA (R03) batteries with correct polarity.
- 3 Close the lid of the battery compartment.

When to replace the batteries

When the dry batteries become weak, the sound will become weak and distorted. Replace both dry batteries with new ones.

Choosing the power source

Set the **BATT SELECTOR** switch to the source you want to use.

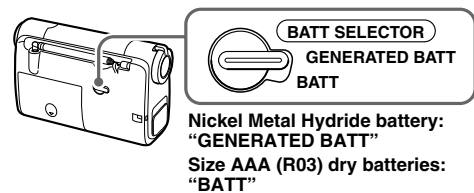

Checking the batteries

Check the rechargeable battery and the dry batteries once a year.

Rechargeable battery:

Turn the **POWER GENERATOR** handle to charge, then confirm that you can listen to the radio.

Dry batteries:

Turn on the radio to confirm if the sound is not weak or distorted.

Rechargeable battery usage time		(Approx. minutes)	
When using	FM	AM	LIGHT
Built-in rechargeable battery	40*2	60*2	15
When charged for 1 minute*1			

*1 When the **POWER GENERATOR** handle is turned 120 times in one minute

*2 at power output approx. 1 mW

Battery Life		(Approx. hours)	
When using	FM	AM	LIGHT
Sony alkaline size AAA (LR 03)	40 (JEITA*3)	50 (JEITA*3)	30

*3 Measured by JEITA (Japan Electronics and Information Technology Industries Association) standards. The actual battery life may vary depending on the circumstances.

If the battery compartment lid comes off (see fig. C)

- 1 Insert the left claw of the battery compartment lid into the hole on the left side of the battery compartment.
- 2 Slide the right side of the lid into the right side hole of the battery compartment.
- 3 Snap the inner lid into the battery compartment lid. The inner lid is designed to snugly fit the unit. To open the inner lid, turn the unit over and let it drop open.

Playing the Radio

You can listen to the radio by the speaker or a separately sold earphone.

- 1 Set the **BATT SELECTOR** switch to choose the power source.
- 2 Turn on the radio and select **FM** or **AM** with power.
- 3 Tune in to a station with **TUNE**. When the station is tuned in, the **TUNE** indicator lights up in red.
- 4 Adjust volume using **VOL**.

To turn off the radio

Set power to **OFF RADIO**.

To improve radio reception

FM: Extend the telescopic antenna and adjust the length, angle and direction to obtain optimum reception.

Note

Adjust the direction of the antenna by holding the bottom of it. The antenna can be damaged when you move the antenna with excessive force.

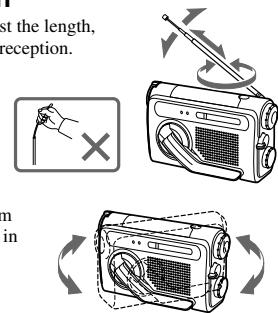

AM: Rotate the unit horizontally for optimum reception. A ferrite bar antenna is built in the unit.

When using a separately sold earphone

Connect the earphone (not supplied) to Ⓜ (earphone) jack. When the earphone is connected, the speaker will not emit sound.

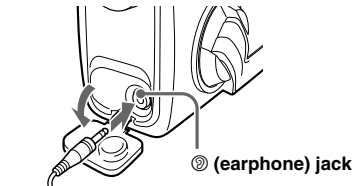

Notes

- When the earphone is not connected to the Ⓜ (earphone) jack, be sure to close the earphone cover. If you do not close the earphone cover, the unit will not be water-resistant.
- When using an earphone, be careful not to expose the unit to water.

Useful functions

Using the LED light

Select the **SOFT LIGHT** or **FLASHLIGHT** using the **LIGHT** switch.

SOFT LIGHT: Turns on the light at the top of the unit.

FLASHLIGHT: Turns on the light at the side of the unit.

To turn off the light, set the **LIGHT** switch to “**LIGHT OFF**.”

Attaching the hand strap

The supplied hand strap is useful when carrying the unit.

To attach the hand strap

Attach the supplied hand strap to the strap hole at the side of the unit.

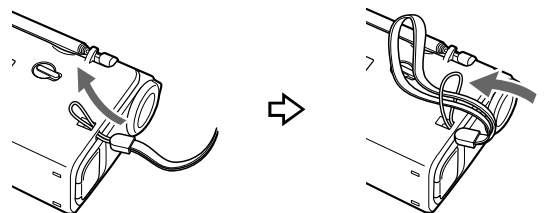

Specifications

Frequency range

FM: 87.5 – 108 MHz

AM: 530 – 1,710 kHz

Speaker

Approx. 3.6 cm (1 7/16 in) dia., 8 Ω

Output

Ⓜ jack (ϕ 3.5 mm, minijack)

Power output

60 mW (Using the built-in rechargeable battery)

90 mW (Using size AAA (R03) dry batteries, not supplied)

Power requirements

Built-in Nickel Metal Hydride (2.4 V, 700 mAh, Ni-MH) battery or 3 V DC, two size AAA (R03) dry batteries

Dimensions

Approx. 130 \times 77 \times 52 mm (w/h/d)

(5 1/8 \times 3 1/8 \times 2 1/8 in)

Mass

Approx. 285 g (10.1 oz)

Approx. 297 g (10.5 oz) (incl. batteries)

Supplied accessory

Hand strap (1)

Design and specifications are subject to change without notice.



Lead-free solder is used for soldering. Halogenated flame retardants are not used in printed wiring boards.