

MDR-501LP/605LP

SERVICE MANUAL

Ver 1.1 2003.12



Photo : MDR-501LP

US Model

MDR-501LP/605LP

Canadian Model

AEP Model

E Model

MDR-605LP

SPECIFICATIONS

Driver units	: 40 mm dia. 40 ohms at 1kHz
Power handling capacity	: 0.5W
Sensitivity	: 104 dB/mW (501LP), 106 dB/mW (605LP)
Frequency response	: 12 – 24,000Hz
Mass	: Approx. 145 g (5 oz) (without cord)
Cord	: Approx. 3 m (118 1/8 inch) long OFC litz cord with a gold-plated stereo unimatch plug

Design and specifications are subject to change without notice.

STEREO HEADPHONES

EXPLODED VIEW AND PARTS LIST

- NOTE :
- Items marked “ * ” are not stocked since they are seldom required for routine service. Some delay should be anticipated when ordering these items.
 - The mechanical parts with no reference number in the exploded views are not supplied.

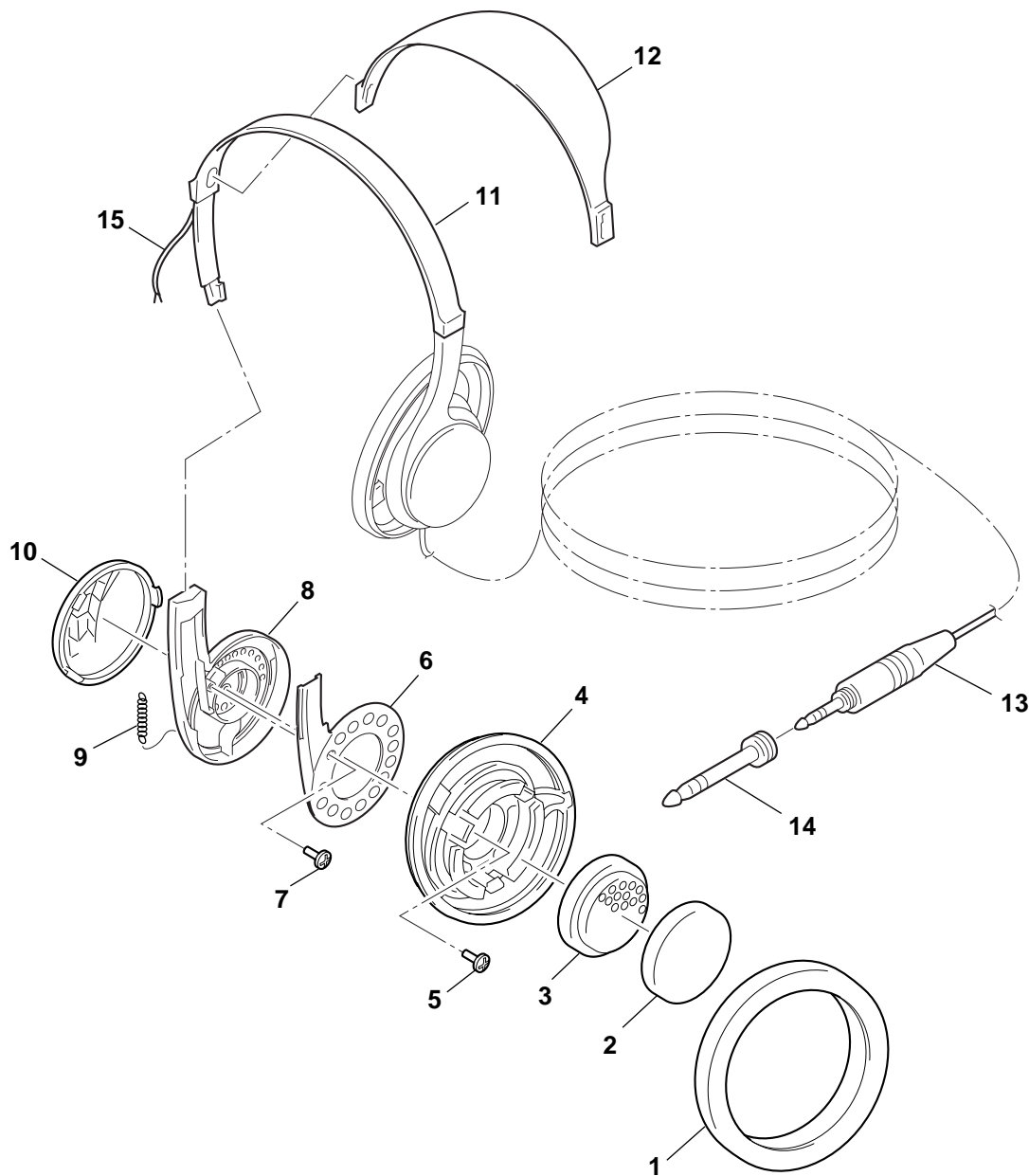

Ref. No.	Part No.	Description	Remark	Ref. No.	Part No.	Description	Remark
1	4-900-124-01	PAD (B), EAR (605LP)		8	4-900-118-01	SLIDER (L)	
1	4-900-126-01	PAD (B), EAR (501LP)		8	4-900-119-01	SLIDER (R)	
2	4-967-003-21	PAD, EAR		9	4-900-127-01	SPRING, TENSION	
3	1-505-967-11	DRIVER ASSY (501LP)		10	4-900-122-01	CAP, HOUSING	
3	X-4950-156-1	DRIVER ASSY (605LP)		11	4-900-116-01	BAND, HEAD	
* 4	4-900-123-01	FRAME		12	4-900-117-01	SUSPENDER	
5	4-900-125-01	SCREW, STEP		13	1-783-564-11	CORD (WITH PLUG)	
6	4-900-120-01	LID (L), SLIDER		14	1-506-589-11	PLUG ADAPTOR	
6	4-900-121-01	LID (R), SLIDER		15	1-783-565-12	CORD	
7	7-685-103-19	SCREW +P 2X5 TYPE2 NON-SLIT					

MEMO

REVISION HISTORY

Clicking the version allows you to jump to the revised page.

Also, clicking the version at the upper right on the revised page allows you to jump to the next revised page.

[illegible]