

MDR-AV3/AV5

SERVICE MANUAL



US Model
Canadian Model
AEP Model
UK Model
E Model

SPECIFICATIONS

Type	Dynamic, closed
Driver units	ø30mm, dome type
Impedance	24 ohms at 1kHz
Sensitivity	98 dB/mW
Power handling capacity	500mW
Frequency response	20 – 20,000Hz
Cord	Approx. 5m long OFC litz cord with a goldplated stereo unimatch 2 way plug
Weight	Approx. 200g (without cord)

Design and specifications subject to change without notice.

1. MOUNTING DIAGRAM

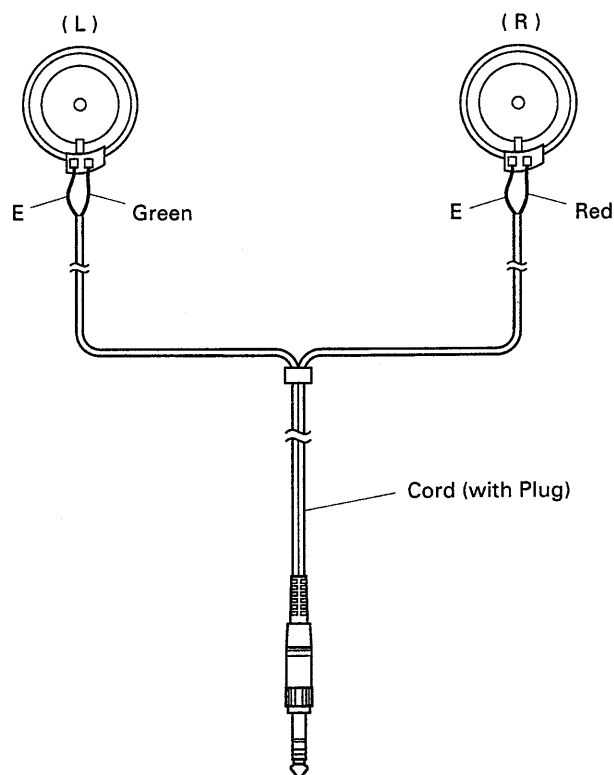

STEREO HEADPHONES
SONY®

2. EXPLODED VIEW AND PARTS LIST

NOTE:

- -XX, -X mean standardized parts, so they may have some differences from the original one.
- Color Indication of Appearance Parts
Example:
KNOB,BALANCE(WHITE)...(RED)
- Items marked “*” are not stocked since they are seldom required for routine service. Some delay should be anticipated when ordering these items.
- The mechanical parts with no reference number in the exploded views are not supplied.

Example:

KNOB,BALANCE(WHITE)...(RED)

↑ ↑

Parts color Cabinet's color

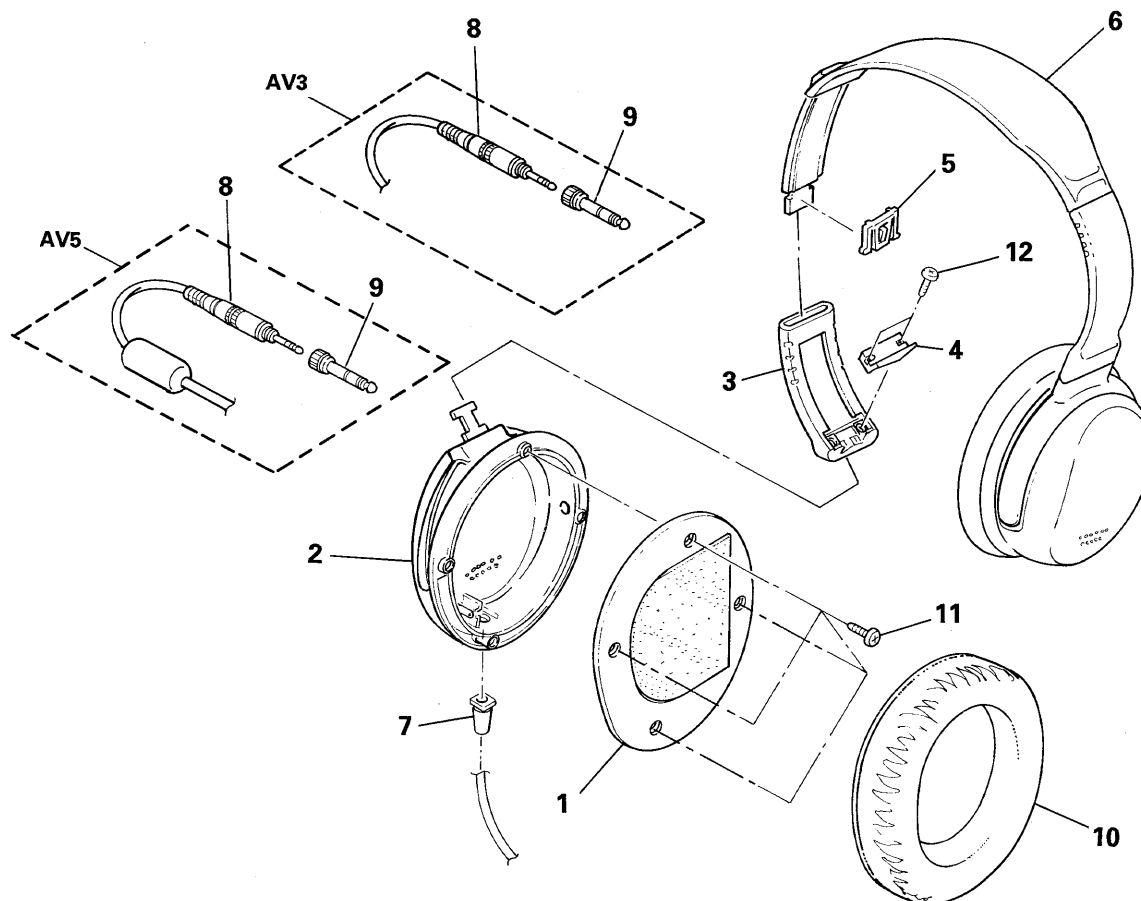

Ref. No.	Part No.	Description	Remarks	Ref. No.	Part No.	Description	Remarks
1	* X-4942-061-1	PLATE (L), FRONT ASSY		6	* 4-945-358-01	HEAD BAND	
1	* X-4942-062-1	PLATE (R), FRONT ASSY		7	* 2-135-236-01	BUSHING	
2	* X-4942-059-1	HOUSING (L) ASSY (AV3)		8	* 1-574-385-21	CORD (WITH PLUG) (AV3)	
2	* X-4942-060-1	HOUSING (R) ASSY (AV3)		8	* 1-690-439-21	CORD (WITH PLUG) (WITH SWITCH, VARIABLE RESISTOR) (AV5)	
2	* X-4942-063-1	HOUSING (L) ASSY (AV5)		9	1-506-589-11	ADAPTOR, PLUG	
2	* X-4942-064-1	HOUSING (R) ASSY (AV5)					
3	* 4-945-003-01	SLIDER		10	4-944-998-01	EAR PAD	
4	* 4-945-004-01	SLIDER COVER		11	7-685-132-19	SCREW +P 2.6X5, TYPE2, SLIT	
5	* 4-945-002-01	SLIDER SPRING		12	7-685-103-19	SCREW +P 2X5, TYPE2, SLIT	

English

9111986-1

Printed in Japan

© 1991.9

Sony Corporation

General Audio Group

- 2 -

Published by Customer Relations and Service Group