

MDR-CD555/CD666

SERVICE MANUAL

Discard MDR-CD555 SERVICE MANUAL
(No. 9-953-551-11) previously issued.
This SERVICE MANUAL contains it.

SPECIFICATIONS

Type	Dynamic, closed
Driver units	φ 30mm Titanium- evaporated diaphragm, dome type
Impedance	45 ohms at 1 kHz
Sensitivity	106 dB/mW
Power handling capacity	500mW
Frequency response	5-27,000 Hz
Cord	Approx. 3m long LC-OFC litz cord with a gold- plated stereo unimatch plug
Weight	Approx. 210g (without cord)

1. DISASSEMBLY

[DRIVER REMOVAL]

- Follow the disassembly procedure in the numerical order given.

Remove 4 latches as illustrated.

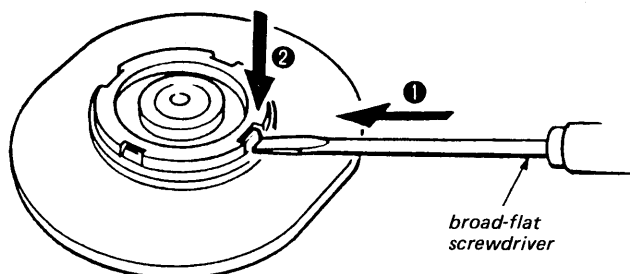

[EAR PAD INSTALLATION]

- Insert ear pad in the groove of housing as illustrated.
- After that, set ear pad in housing by pushing it.

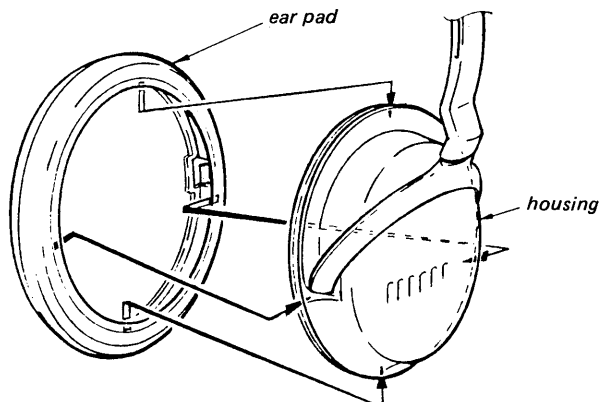

US Model
MDR-CD555/CD666
Canadian Model
AEP Model
UK Model
E Model
MDR-CD555

2. MOUNTING DIAGRAM

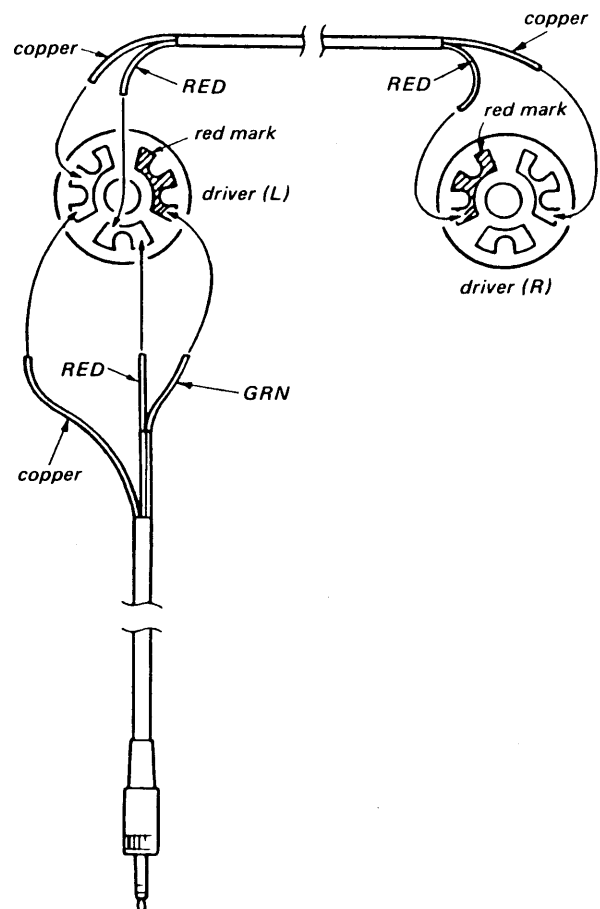

STEREO HEADPHONES
SONY®

3. EXPLODED VIEW AND PARTS LIST

NOTE:

- The mechanical parts with no reference number in the exploded views are not supplied.
- The construction parts of an assembled part are indicated with a collation number in the remark column.
- Items marked "*" are not stocked since they are seldom required for routine service. Some delay should be anticipated when ordering these items.
- Due to standardization, parts with part number suffix -XX and -X may be different from the parts specified in the components used on the set.
- Screw (# mark) list is given in the last of this parts list.

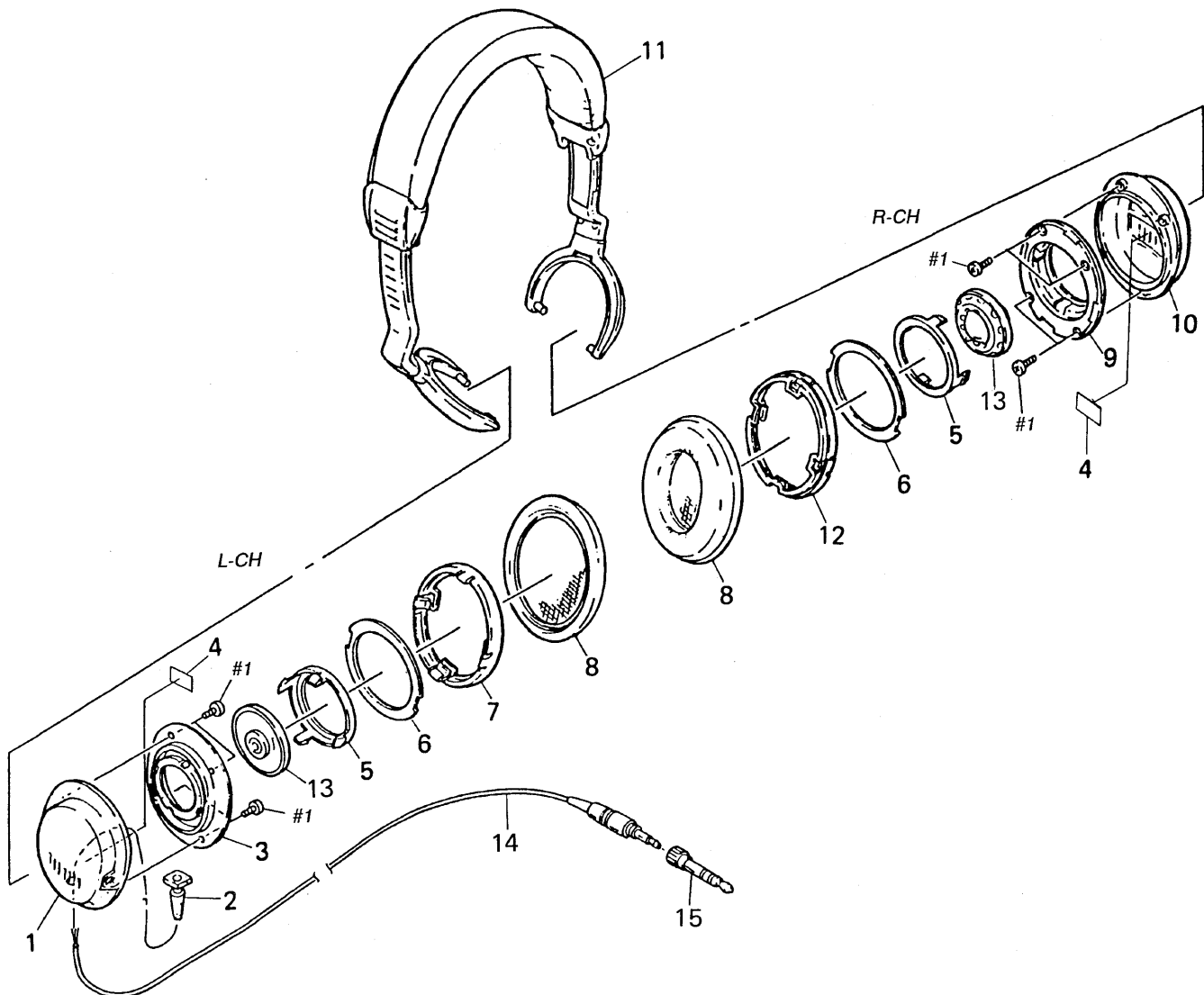

Ref. No.	Part No.	Description	Remark	Ref. No.	Part No.	Description	Remark
1	2-133-159-01	HOUSING (B) (L) ... (CD555)		10	2-133-160-01	HOUSING (B) (R) ... (CD555)	
1	4-944-009-01	HOUSING (B) (L) ... (CD666)		10	4-944-010-01	HOUSING (B) (R) ... (CD666)	
2	2-133-171-01	BUSHING		11	X-2133-106-1	BAND ASSY. HEAD ... (CD555)	
3	* 2-133-161-01	PLATE (B) (LEFT), FRONT		11	X-4941-520-1	BAND ASSY. HEAD ... (CD666)	
4	2-133-127-01	REGISTER, HOUSING		12	2-133-166-01	RING (RIGHT), EAR PAD	
5	2-113-173-01	STOPPER, DRIVER		13	1-505-088-21	DRIVER	
6	2-133-139-01	REGISTER (B), FRONT		14	1-559-100-21	CORD (WITH PLUG)	
7	2-133-165-01	RING (LEFT), EAR PAD		15	1-506-589-11	ADAPTER, PLUG	
8	X-2133-105-1	PAD ASSY, EAR		#1	7-685-102-19	SCREW +P 2X4 TYPE2 NON-SLIT	
9	* 2-133-162-01	PLATE (B) (RIGHT), FRONT					